

IDENTIFICATION OF CORES

4 X 95 sq.mm LV ABC ITEM NUMBER 197665  
 4 X 150 sq.mm LV ABC ITEM NUMBER 415591

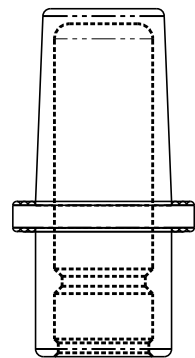

DETAIL A - ABC CABLE SEAL (95-150mm)  
 ITEM NUMBER 504107

CHARACTERISTIC	4 x 95sq.mm	4 x 150sq.mm
NUMBER OF CORES	4	4
FORM OF CONDUCTORS	STRANDED,CIRCULAR,COMPACTED	STRANDED,CIRCULAR,COMPACTED
NUMBER OF WIRES IN CONDUCTOR	19 +/- 1	19
DIAMETER OF CONDUCTOR	- MIN. 11.3 mm - MAX. 11.9 mm	14.1 mm 14.9mm
CALCULATED MAX. DIAMETER OF CIRCUMSCRIBING CIRCLE OVER LAID-UP CORES.	38.4 mm	45.6mm
MAXIMUM A.C. RESISTANCE OF CONDUCTOR IN CABLE AT 80 DEG CENTIGRADE.	0.398 ohms/km	0.084 ohms/km
APPROXIMATE MASS OF CABLE	1.35 kg/m	2 kg/m
POSITIVE SEQUENCE REACTANCE OF CABLE AT 50 Hz.	0.0853 ohms/km	0.0844 ohms/km
MAXIMUM CONTINUOUS CURRENT CARRYING CAPACITY PER PHASE.	215 A	280 A
MINIMUM BREAKING LOAD (MBL) OF CABLE	53.2 kN	84 kN
MODULUS OF ELASTICITY OF CONDUCTOR	56 GPa	56 GPa
MINIMUM BENDING RADIUS OF CABLE.	345 mm	410 mm
HIGHEST VALUE FOR MAXIMUM WORKING TENSION (28 % MBL)	14.9 kN	23.5 kN
HIGHEST VALUE FOR EVERYDAY TENSION (18% MBL)	9.60 kN	15.12 kN
CABLE LENGTH PER DRUM	500 m	500 m
XLPE INSULATION GRADE	UV STABILIZED X-90 XLPE REFER NOTE 2	
XLPE INSULATION COLOUR	BLACK	BLACK
VOLTAGE RATING	0.6/1 kV	0.6/1 kV

NOTES

- CABLE MUST COMPLY WITH AS 3560.
- MINIMUM CARBON BLACK TO BE 2% WITH DISPERSION <5 AS PER AS1660.2.4
- ALL UNATTENDED ABC CONDUCTOR ENDS SHALL BE CAPPED. REFER TO DETAIL A.

8 CABLE CAP DETAIL ADDED 7 4 x 150sq.mm ABC ADDED, NOTE 2 ADDED, X-FP-90 CHANGED TO UV STABILIZED X-90 6 NOTE 2 CHANGED 5 AS UPDATED TO 2000 4 NOTE 2 ADDED. TITLE CHANGED. 3 INSULATION CHANGED TO COMPLY WITH LATEST AS 3560. 2 INSULATION CHANGED TO TYPE 2. RESISTANCE AMENDED. 1 TITLE AMENDED - 95 mmsq TO 95 sq.mm	P.H. J.C. J.C. K.I. J.A.L. gmck B.G. pmc	I.B. A.T. A.T. C.C. S.C.M. - - -	B.C. S.C. S.C. C.C. P.J.D. N.S. N.S. A.T.	DEC'17 MAR'12 MAR'08 SEP'05 JUL'95 FEB'92 MAR'90 FEB'90		DES -	N.T. STANDARD		
						DRN H.T.	CONDUCTOR LV - ABC ALUMINIUM 4 X 95 AND 4 X 150 sq.mm XLPE GRADE X-90		
						CKD G.SCHUBERT			
						APPD B.T.KENT			
						SCALE N.T.S			
						ISSUED SEP'89	A3	DRAWING NUMBER	S04-1-1-1
ALL DIM. IN mm									
No.	AMENDMENT	DRAWN	CHKD	APPD	DATE	DRAFTING STANDARD TO AS 1100	CAD PRODUCT — DO NOT AMEND MANUALLY	AMDT	