

THREE TRANSFORMER SUBSTATION
SUBSTATION SIZE MIN 11000 x 2500

NOTES

1. FOR CONDUIT SCHEDULE AND ASSOCIATED REFERENCE DRAWINGS REFER DRAWING No. S02-2-7-43.
2. ADDITIONAL STEPS (UP TO A MAXIMUM OF 3) INCLUDING APPROPRIATE HANDRAIL MAY BE PROVIDED AT ANY PERSONNEL DOORWAY. IF THE STEPS ARE TO BE LOCATED WITHIN THE SUBSTATION CHAMBERS, IT WILL BE NECESSARY TO EXTEND THE SUBSTATION CHAMBER TO ACCOMMODATE THE ENCROACHMENT OF THE STEPS, SUCH THAT THE INTERNAL DIMENSIONS OF THE SUBSTATION CHAMBER ARE NOT REDUCED.
3. SUBSTATION DIMENSIONS WILL VARY DEPENDING ON THE LOCATION IN WHICH EQUIPMENT IS INSTALLED. THROUGH OUT THE SUBSTATION CHAMBER A MINIMUM OF 1000mm CLEAROPENING SHALL BE PROVIDED FROM ANY STRUCTURE TO EQUIPMENT AND A MINIMUM OF 900mm BETWEEN EQUIPMENT.

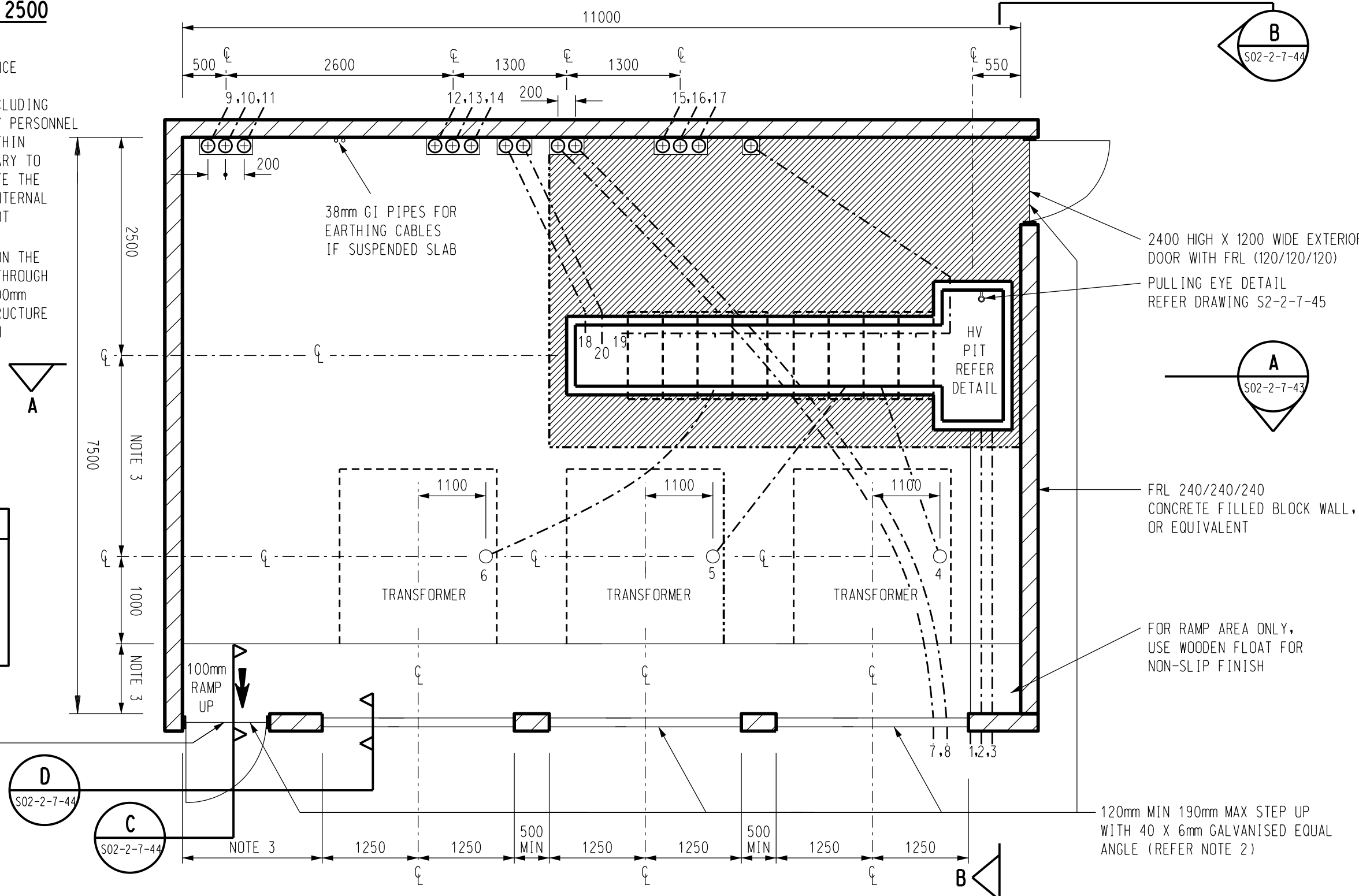

LEGEND

	RAISED FLOOR LINE
	RAISED FLOOR AREA

PLAN VIEW
SCALE 1:50

NO	DESCRIPTION	DRN	DATE	CKD	APPD
3	DIMENSIONS AMENDED	A.B.	JAN'17	I.B.	B.C.
2	NOTE 3 ADDED, DIMENSIONS AMENDED, DOORS UPDATED	C.C.	JUN'14	A.T.	B.C.
1	UPDATE DOOR SWING	K.I.	SEP'06	R.S.	S.C.
AMENDMENTS					



DES	I. PURVES	POWER STANDARD DRAWING	
DRN	G.R./A.D.	THREE TRANSFORMER INDOOR SUBSTATION SURFACE CHAMBER - OPTION 3	
CKD	S. LEACH		
APPD	F. ROBSON		
SCALE	N.T.S.	CONSTRUCTION DETAILS SHEET 1 of 3	
ISSUED	MARCH'98	A3	DRAWING NUMBER
ALL DIM.	IN mm		S02-2-7-42
DRAFTING STANDARD TO A.S.1100		CAD PRODUCT - DO NOT AMEND MANUALLY	

