

TAG

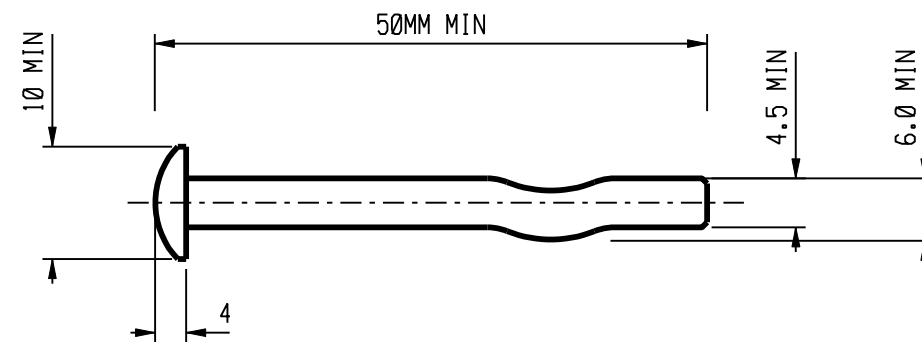

SPIKE

MATERIAL:

HIGH GRADE STAINLESS STEEL
FOR BOTH TAG AND SPIKE

NOTE:

SEE DRAWING S02-2-6-27
FOR INSTALLATION PROCEDURE

KERB MARKER TAG & SPIKE:

STOCK CODE: 406859

						DES C.T.F		POWER STANDARD DRAWING	
						DRN K.I.		SIGN CABLE ROUTE MARKER KERB	
						CKD C.C.			
						APPD C. C			
						SCALE NTS			
						ISSUED AUG '05		A3	
						ALL DIM. IN mm		DRAWING NUMBER S02-1-8-28	
						DRAFTING STANDARD TO A.S.1100		CAD PRODUCT - DO NOT AMMEND MANULLY	
								AMD T	

2	STOCK CODE ADDED	A.S.	NOV'06	B.C.	S.C.
1	SPIKE & TAG DIMENSION UPDATED	K.I.	DEC'05	C.C.	C.C.
0	ISSUED FOR CONSTRUCTION	K.I.	AUG'05	C.C.	C.C.
NO	DESCRIPTION	DRN	DATE	CKD	APPD
AMENDMENTS					

