

PLAN

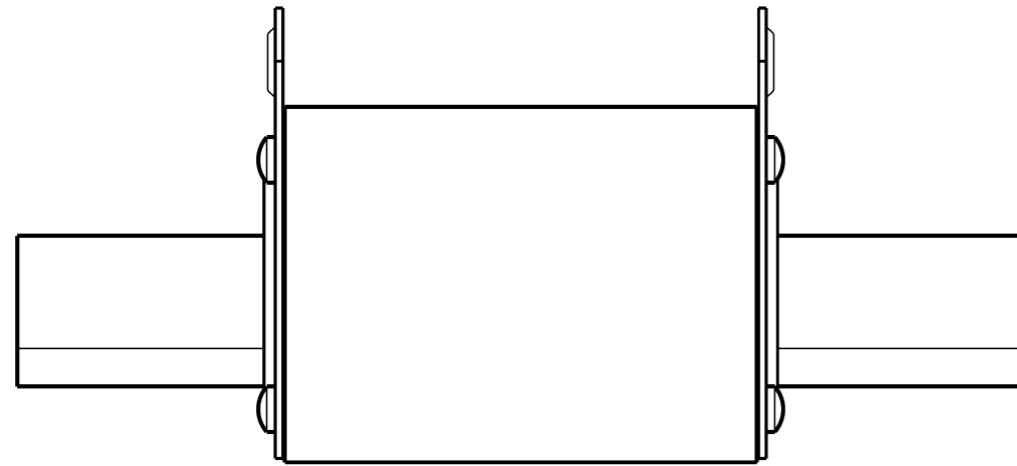

ELEVATION

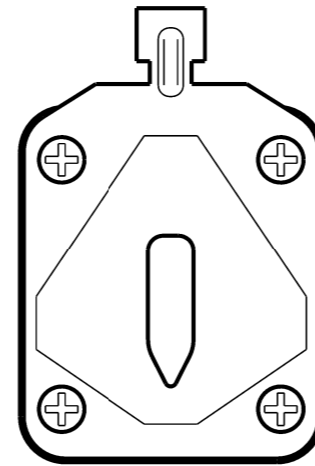

END ELEVATION

ITEM	STOCK CODE	CURRENT RATING	SIZE
11	286211	63A	00
12	286229	80A	00
13	286237	100A	00
14	286245	125A	00
15	205088	160A	00
1	10058	63A	1
2	10066	100A	1
3	11064	160A	1
4	9712	200A	1
5	11072	250A	1
6	9761	315A	2
7	9720	355A	2
8	9738	400A	2
9	9746	500A	3
10	9753	630A	3

TECHNICAL DATA

VOLTAGE - 500v AC 120kA
 ACCORDING TO DIN43-620 & IEC 60269 - 2

FAST ACTING

FUSES MUST COMPLY WITH AS 2005.1

INSULATED EXTRACTION TAGS NOT ACCEPTABLE.

REFER DRGS: S02-1-4-08, S02-1-4-11.

NO	DESCRIPTION	DRN	DATE	CKD	APPD
12	SIZE 00 STOCK CODES ADDED	A.T.	APR'12	B.C.	S.C.
11	TABLE AND TECHNICAL DATA AMENDED	A.S.	DEC'04	R.C.	C.C.
10	JEAN MULLER ITEM ADDED, TITLE CHANGED.	RG1	APR'01	MB	FRR
9	TECHNICAL DATA ADDED.	-	- / - -	-	MCA
8	TITLE AND DRAWING NUMBER CHANGED.	-	MAY'88	-	QLT
AMENDMENTS					

PowerWater	DES	K.CHITT	POWER STANDARD DRAWING	
	DRN	B.TOLSON	FUSES AND SWITCHGEAR CARTRIDGE STRIPLE FUSE 63A - 630A	
	CKD	R.HAIGH		
	APPD	K.CHITT		
	SCALE	1:1	A3	DRAWING NUMBER
ISSUED	NOV'82			
ALL DIM. IN mm		CAD PRODUCT - DO NOT AMEND MANUALLY		
DRAFTING STANDARD TO A.S.1100		AMDT		