

**ASSEMBLY 1
TERMINATION BIMETAL LIVE LINE TYPE CU**

NOTES:

1. A SUITABLE INHIBITOR COMPOUND SHALL BE APPLIED TO CLEAN BRUSHED CONDUCTOR WHERE ALUMINIUM CONDUCTORS ARE USED.
2. WHERE-EVER POSSIBLE BOLTED CONNECTORS SHOULD NOT BE ATTACHED TO CONDUCTOR UNDER TENSION.
3. MAINS AND SERVICE CONNECTORS SHOULD MEET THE REQUIREMENTS FOR NON-TENSION CONDUCTORS AS SHOWN IN AS 1154.
4. BELL MOUTH LUGS REQUIRED WHEN LUGGING FLEX COPPER DROPPERS
5. CONNECTION TYPE CB SHALL BE USED ON ALL HV FEEDER BACKBONES AND ALL FEEDER INTERCONNECTIONS AND REQUIRES 2 PG CLAMPS TO BE USED PER CONNECTION.
6. CONNECTION TYPE CU SHALL BE USED ON:
 - TRANSFORMER CONNECTIONS
 - UNDER GROUND CABLE TERMINATIONS AND SWITCHGEAR NOT ON THE HV BACKBONE
 - SPUR LINE TEE-OFFS

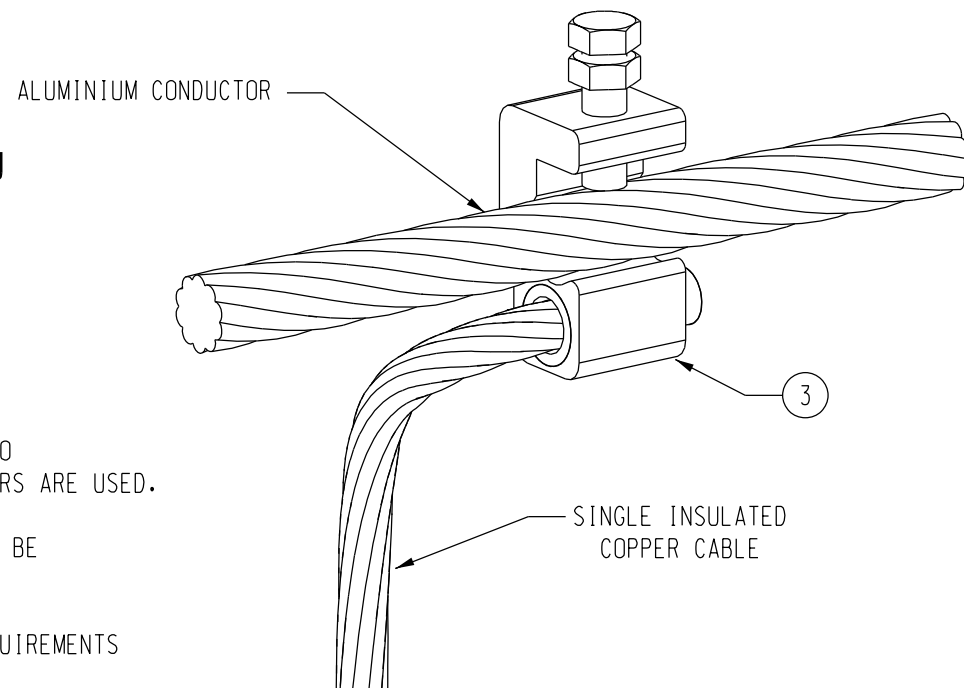

**ASSEMBLY 7
TERMINATION BIMETAL
SINGLE SERVICE TYPE CSS**

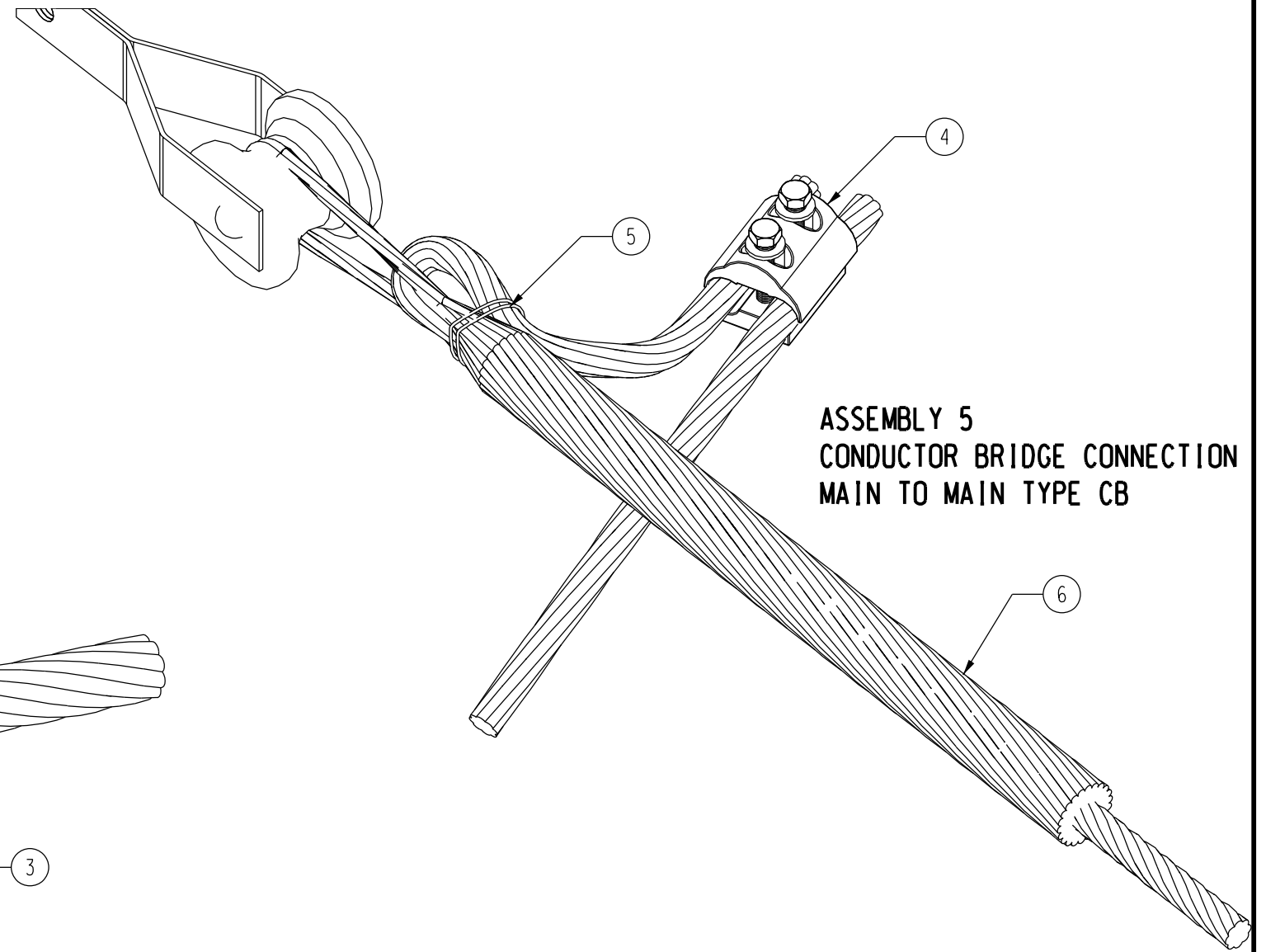

**ASSEMBLY 5
CONDUCTOR BRIDGE CONNECTION
MAIN TO MAIN TYPE CB**

DEV	CB	CSS	Cu	QUANTITY	ITEM	DESCRIPTION	ITEM NUMBER
			1	7		BELL MOUTHED M12 COMPRESSION LUG	406766
1				6		DEAD END
AS REQ				5		TIE WIRE 0.5mm ALUMINIUM ANEALED
1	1			4		CLAMP PARALLEL GROOVE (S01-1-4-25)
		1		3		CLAMP ALUMINIUM TO COPPER	502127
			1	2		LIVE LINE CLAMP GP (S01-1-4-17)	2121
			1	1		ALUMINIUM BAIL CLAMP (S01-1-4-10)	239020

NO	DESCRIPTION	DRN	DATE	CKD	APPD
15	ITEM NUMBER UPDATED	P.H.	APR'18	I.B.	B.C.
14	ITEM 1 UPDATED	K.T.	APR'16	I.B.	B.C.
13	MATERIAL TABLE UPDATED	A.T.	JAN'15	I.B.	B.C.
12	NOTE 5 & 6 ADDED	C.C.	AUG'11	A.T.	S.C.
11	DRAWING REF. & STOCK CODES UPDATED	C.M.	MAY'10	A.T.	S.C.
10	ASSEMBLY 1 UPDATED, REDRAWN IN 3D	J.C.	SEP'09	A.T.	S.C.



DES	A.TAYLOR	POWER STANDARD DRAWING	
DRN	J.COPPINS	ASSEMBLIES MAIN AND SERVICE CONNECTIONS AND TERMINATIONS	
CKD	A.TAYLOR		
APPD	S.C.		
SCALE	N.T.S	A3	DRAWING NUMBER S01-2-1-01
ISSUED	SEP'09		
ALL DIM.	IN mm	DRAFTING STANDARD TO A.S.1100	
CAD PRODUCT - DO NOT AMEND MANUALLY		AMDT 15	