

**TOP VIEW**

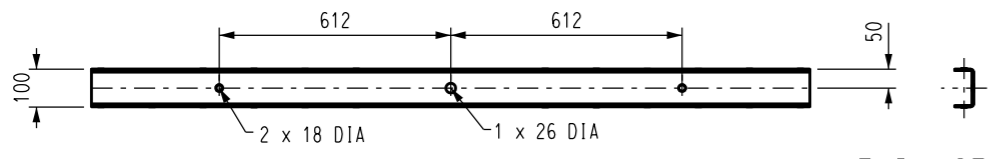
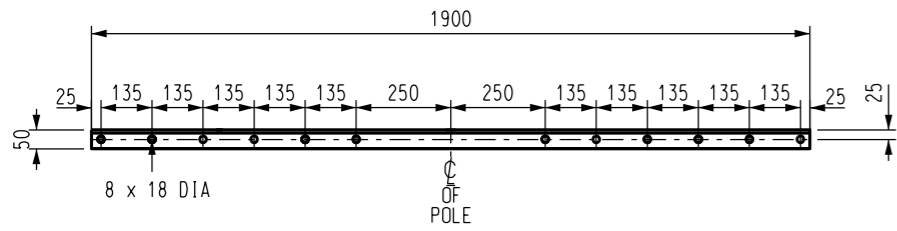

**FRONT VIEW**

**END VIEW**

**LV - SERVICE**

MATERIAL: 100x50x4 DURAGAL CC  
ITEM NUMBER: 298554

**TOP VIEW**

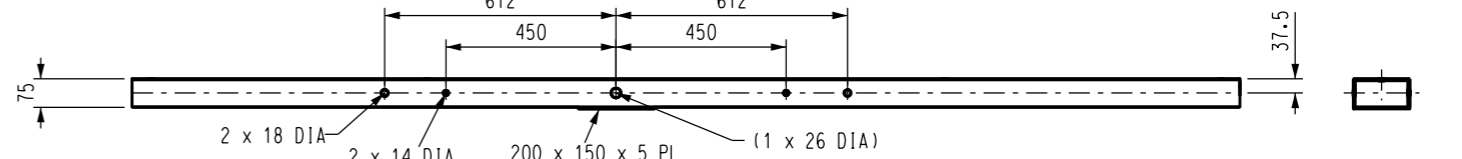
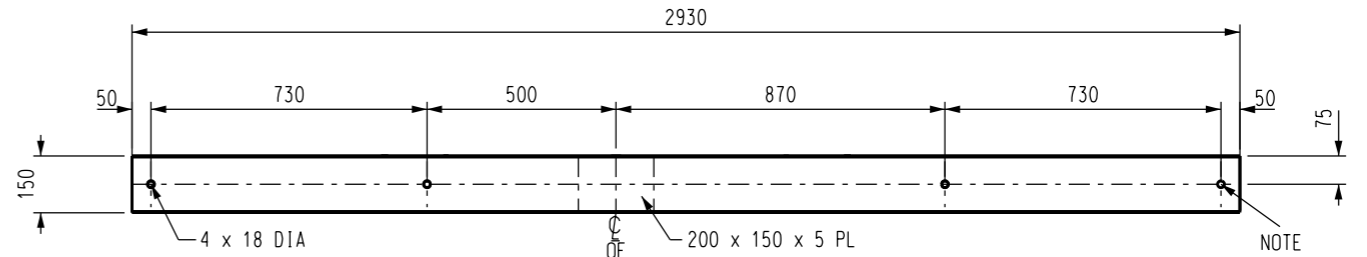

**FRONT VIEW**

**END VIEW**

**LV - TRUNCATED DEVIATION**

MATERIAL: 150x75x5 DURAGAL CC  
STRENGTH: 5.5kN  
ITEM NUMBER: 298570

**TOP VIEW**

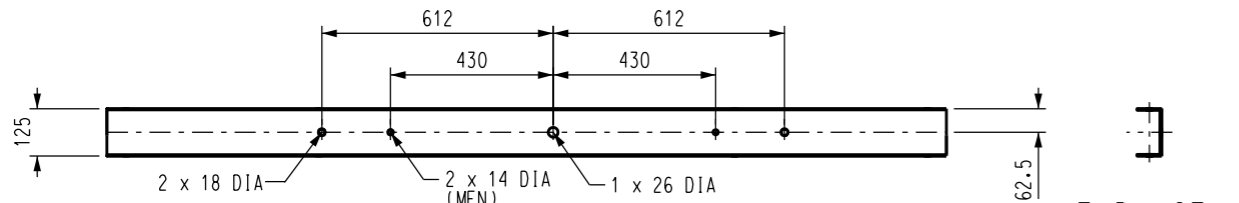
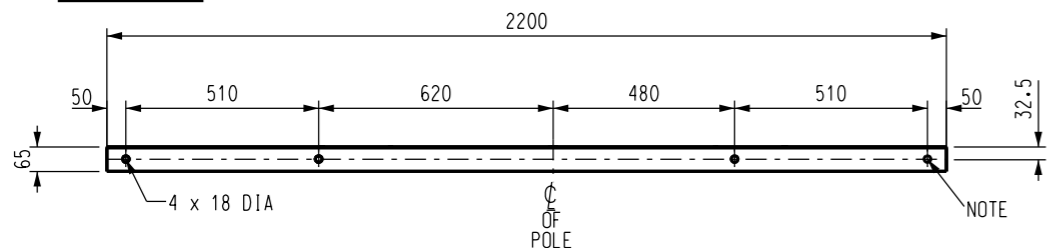

**FRONT VIEW**

**END VIEW**

**LV - LINE, 4 WIRE**

MATERIAL: 125x65x4 DURAGAL CC  
STRENGTH: 8.2kN (STRONG DIRECTION)  
ITEM NUMBER: 298562

**TOP VIEW**

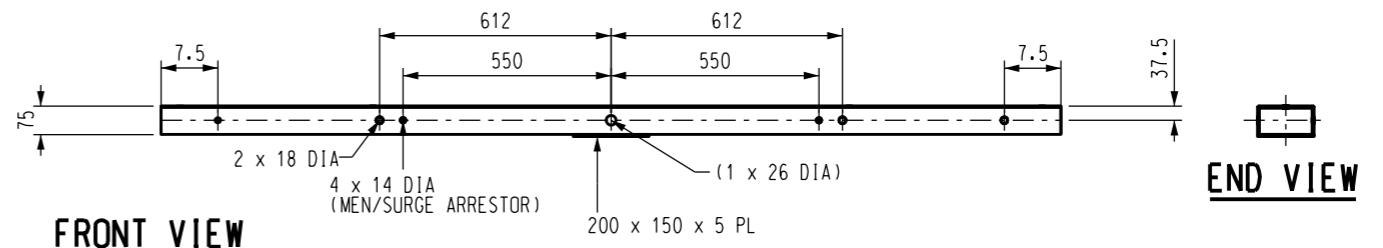
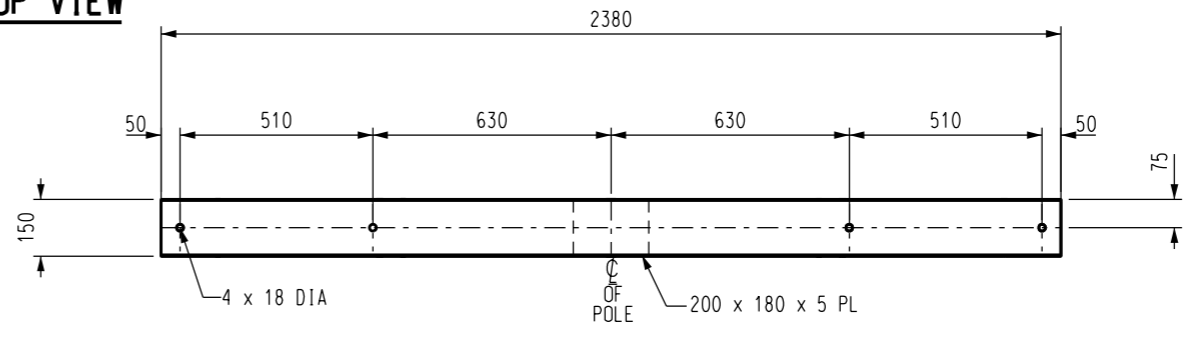

**FRONT VIEW**

**END VIEW**

**LV - TERMINATION, 4 WIRE**

MATERIAL: 150x75x9.5 HOT DIPPED GALVANIZED PFC  
ITEM NUMBER: 500498  
  
MATERIAL: 150x75x5 DURAGAL CC  
ITEM NUMBER: 298588  
STRENGTH: 8.9kN

**NOTES:**

- ALL HOLES ARE TO BE ON BOTH SIDES OF THE CHANNEL.
- DURAGAL MATERIAL SHALL BE GRADE 450.

NO	DESCRIPTION	DRN	DATE	CKD	APPD
5	NOTE 2 ADDED, LV TERMINATION, PFC MATERIAL AMENDED	P.H.	APR'18	I.B.	B.C.
4	MEASUREMENT ON LV LINE 4 WIRE UPDATED	C.C.	DEC'14	A.T.	B.C.
3	TERMINATION CROSSARM UPDATED, LINE ARM EXTENDED	A.T.	AUG'12	B.C.	S.C.
2	HOLE CENTRE LINES EXTENDED, NOTE ADDED	J.C.	APR'08	B.C.	S.C.
1	NOTE ADDED	J.C.	APR'08	B.C.	S.C.
0	ISSUED FOR CONSTRUCTION	A.S.	7.3.01	M.B.	F.R.R.
<b>AMENDMENTS</b>					



DES	M. BOCK	POWER STANDARD DRAWING	
DRN	R. INNES		
CKD	M. BOCK	CROSSARMS, LV BOLTED CONNECTIONS FOR UNIVERSAL POLE CONSTRUCTION	
APPD	F. ROBSON		
SCALE	1:200	A3	DRAWING NUMBER S01-1-2-11
ISSUED	DEC'2000		
ALL DIM.	IN mm	DRAFTING STANDARD TO A.S.1100	
CAD PRODUCT - DO NOT AMEND MANUALLY		5 AMDT	