

PARTS LIST		
ITEM	DESCRIPTION	QTY
1	500 SQ x 500 DEEP CONCRETE FOOTING	0.1 m ³ Approx
2	1.6PL SS CAST IN BASE (FOLDED RECTANGULAR SECTION) WITH 300 x 250 x 5 PL SS FLANGE	1
3	1.6PL SS SAMPLE POINT BODY (FOLDED RECTANGULAR SECTION) WITH 300 x 250 x 5 PL SS FLANGE	1
4	1.6PL SS SAMPLE POINT LID (FOLDED RECTANGULAR SECTION)	1
5	1.6PL SS SAMPLE POINT ACCESS PLATE (AS PER DETAIL ON THIS DRAWING)	1
6	75 x 150 x 1.6PL SS PLATE WELDED INSIDE TUBE WITH CENTRALLY PLACED HOLE TO SUIT BULKHEAD FITTING	1
7	40 SS UNDRILLED PIANO HINGE (150 LENGTH)	1
8	DN15 BALL VALVE, BRASS BODY, BALL CERTIFIED TO WATER MARK CIM 11CR	1
9	DN15 INLINE BALL VALVE, COMPACT HANDLE, BRASS BODY, BALL CERTIFIED TO WATER MARK CIM 11CR	1
10	DN15 THREADED COMPRESSION FITTING	1
11	DN15 BULKHEAD COMPRESSION FITTING	1
12	DN15 UNION COMPRESSION FITTING	1
13	PRESS FIT COUPLING	2
14	SPOUT - DN15 COPPER TUBE AS PER AS1432, TYPE B (AS PER DETAIL ON THIS DRAWING)	1
15	DN15 COPPER TUBE AS PER AS1432, TYPE B	2 m Approx
16	ARMAFLEX SOLAR LAGGING 15 THK, WEATHER RESISTANT, PRE-FORMED FOR DN15 TUBE	2 m Approx
17	M10 x 30 SS SOCKET HEAD BOLTS AND M10 NUTS WITH LOCKING WASHERS	4
18	M6 x 30 SS SOCKET HEAD CAP BOLTS	4
19	20 x 20 x 3 PL SS TAB WITH M6 SS 'NUTSERT' (AS PER DETAIL ON THIS DRAWING)	4
20	DN20 PLASTIC METER BOX	1
21	METER BOX COVER - COLOUR: RAW/POTABLE = JADE (GREEN), RECYCLED = LILAC	1
22	SAND BACKFILL	0.02 m ³ Approx
23	TRAFFOLYTE LABEL (NOTE 3)	1

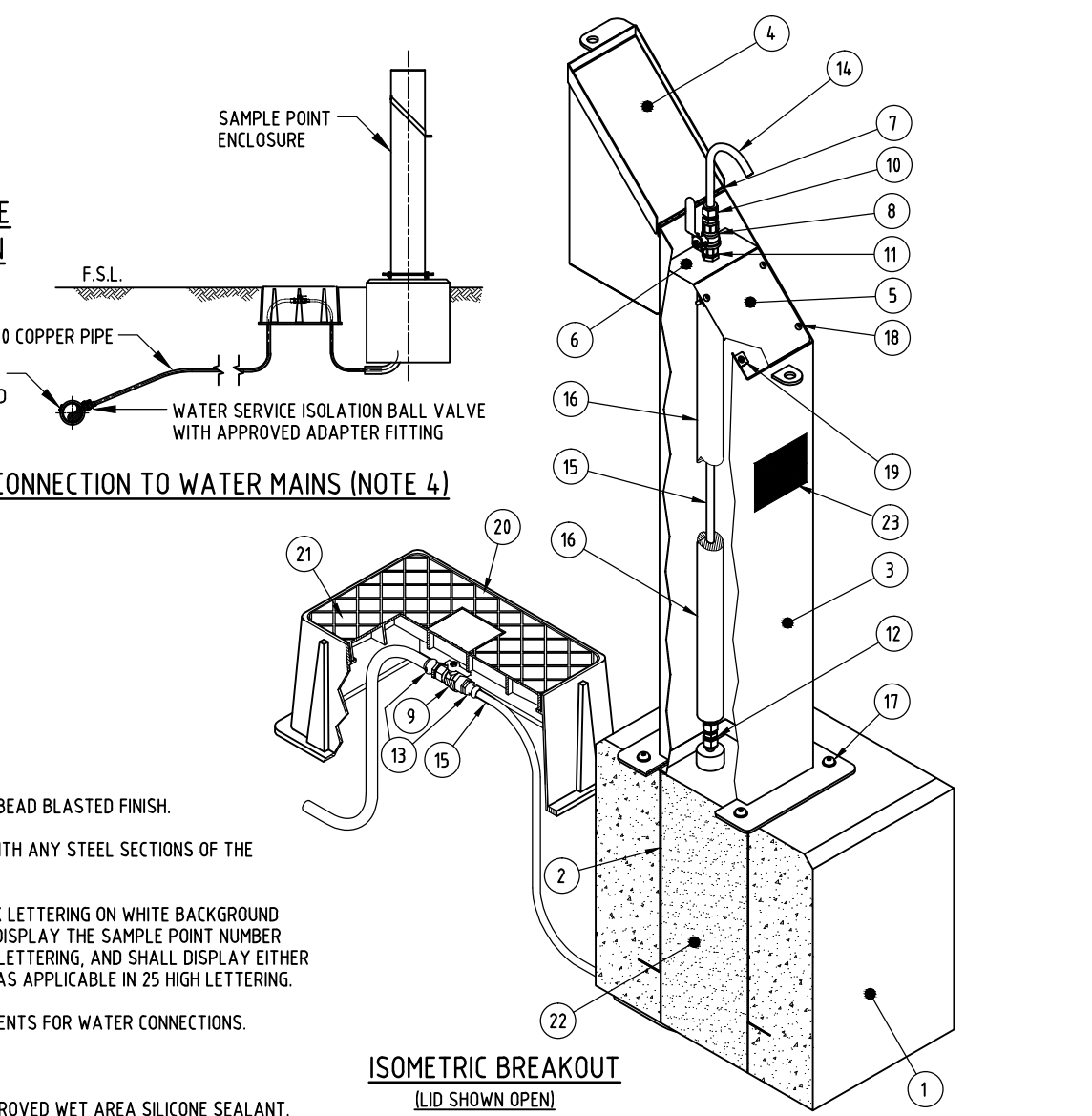

- NOTES**
- ALL EXPOSED STAINLESS STEEL SURFACES SHALL HAVE A BEAD BLASTED FINISH.
 - COPPER PIPE TO BE LAGGED AND NOT IN DIRECT CONTACT WITH ANY STEEL SECTIONS OF THE INSTALLATION.
 - TRAFFOLYTE LABEL TO BE 100 x 100 WITH ENGRAVED BLACK LETTERING ON WHITE BACKGROUND AND FIXED WITH EITHER SCREWS OR RIVETS. LABEL SHALL DISPLAY THE SAMPLE POINT NUMBER ASSIGNED BY POWER AND WATER CORPORATION IN 50 HIGH LETTERING, AND SHALL DISPLAY EITHER "POTABLE WATER", "RAW WATER" OR "RECYCLED WATER" AS APPLICABLE IN 25 HIGH LETTERING.
 - REFER TO PWC STD DRG. W1-1-23A FOR ADDITION REQUIREMENTS FOR WATER CONNECTIONS.
 - ALL EXPOSED CONCRETE EDGES TO HAVE 20 CHAMFER.
 - SEAL ALL-ROUND ITEM 5 UPON INSTALLATION WITH AN APPROVED WET AREA SILICONE SEALANT.

1	NEW DRAWING AND GENERAL AMENDMENT 2021.	PW	JUNE '21	IL	DC
NO	DESCRIPTION	DRN	DATE	CKD	APPD
AMENDMENTS					

--	--	--	--	--	--



DES	DRN	CHK	APPD	SCALE	N.T.S.	WATER STANDARD DRAWING MAINLAYING BACTERIOLOGICAL WATER SAMPLE POINT	A3 DRAWING NUMBER W1-2-15	1 AMDT
ISSUED	JUNE '21	DRAFTING STANDARD TO A.S.1100			CAD PRODUCT - DO NOT AMEND MANUALLY			
ALL DIM. IN mm								