

TOP AND BOTTOM TERMINALS MAY BE:

1. PARALLEL GROOVE TYPE TO SUIT 13mm² - 125mm² Cu or Al CONDUCTORS,
2. SS316 M12X100 STUD, NUT WITH FLAT AND SPRING WASHER

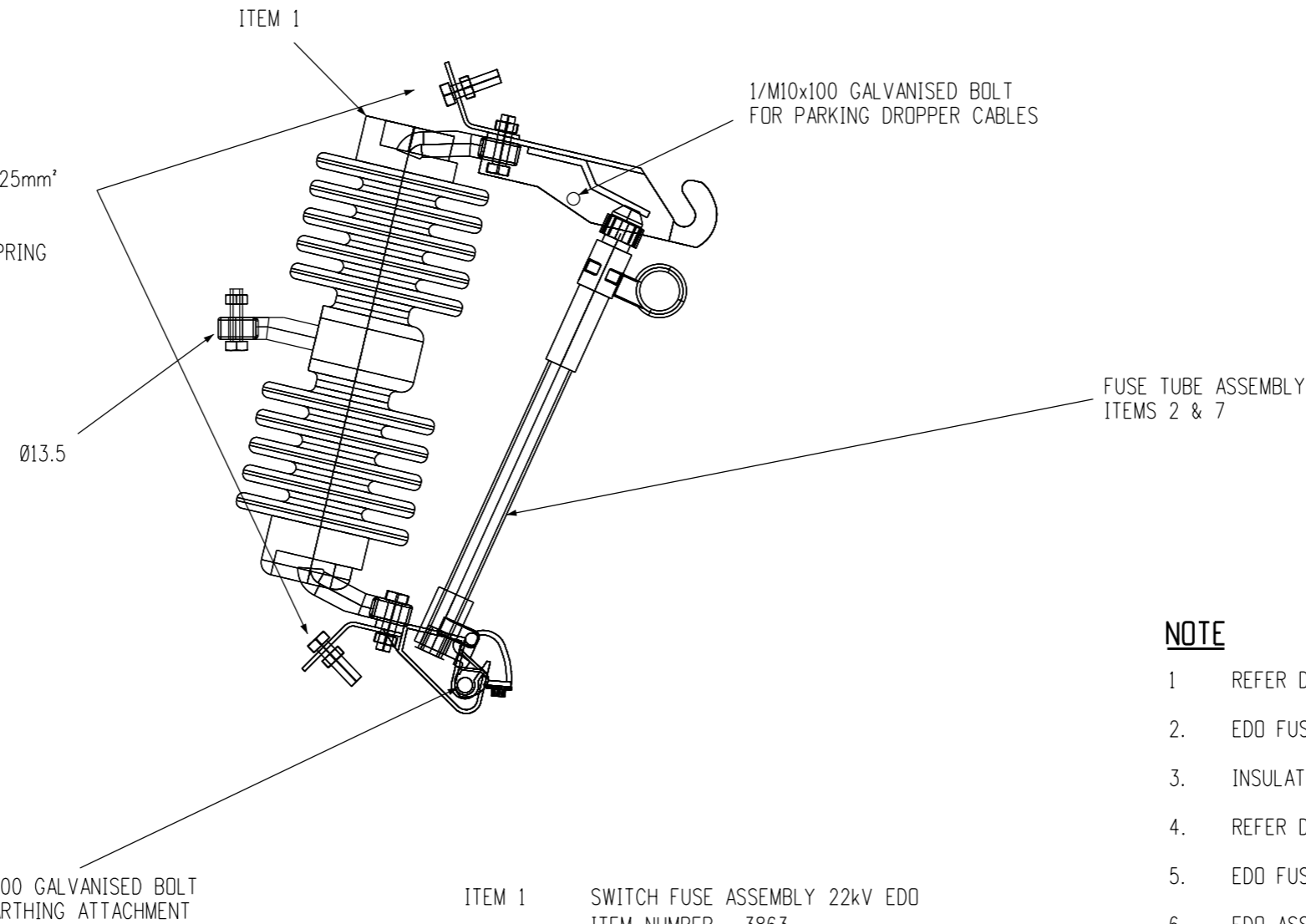

ITEM	1
ITEM NUMBER	3863
RATED VOLTAGE	8kA
RATED NORMAL CURRENT	100A
INTERRUPT CAPACITY	8kA
POWER FREQUENCY WET W/STAND	50kV
B.I.L.	150kV

NOTE

1. REFER DRAWING S01-01-06-05 FOR EDD FUSE LINK SELECTION
2. EDD FUSE TUBES TO BE FITTED WITH ARC SHORTENING RODS
3. INSULATORS TO BE PUNCTURE AND BIRD PROOF AND COMPLY WITH AS 2947
4. REFER DRAWING S01-01-06-07 ITEM 3 FOR 'Z' BRACKET DETAILS
5. EDD FUSE TUBES TO BE FITTED WITH REFLECTIVE TAPE
6. EDD ASSEMBLIES TO COMPLY WITH PWC STANDARD SPECIFICATION STSP 01-010

MATERIAL TYPE

- | | |
|------------------|----------------------------------|
| INSULATOR | - PORCELAIN GLAZED MUNSSELL GREY |
| CONTACT ASSEMBLY | - TINNED COPPER |
| CONTACT FACE | - ELECTROPLATED SILVER |
| MOUNTING BRACKET | - GALVANISED FLAT MILD STEEL |

1/M10x100 GALVANISED BOLT FOR EARTHING ATTACHMENT

- ITEM 1 SWITCH FUSE ASSEMBLY 22kV EDD
ITEM NUMBER - 3863
- ITEM 2 100A TUBE ASSEMBLY EDD
RATED BREAKING CAPACITY 8kA SYM
ITEM NUMBER - 169300
- ITEM 7 200A TUBE ASSEMBLY EDD TYPE C
RATED BREAKING CAPACITY 12kA
ITEM NUMBER - 407372

15	CHANGED MATERIALS AND TITLE, UPDATED FORMATTING TABLE. UPDATED ITEM DESCRIPTIONS. ADDED TERMINAL DETAILS AND NOTES 4, 5 & 6.	A.N.	OCT'20	C.C.C.	B.C.
14	TITLEBLOCK & DRAWING NUMBERS FORMATTED	K.T.	DEC'18	C.C.	C.C.
13	REDAWN IN CAD, ITEMS 2, 4, 5, 6 REMOVED, ITEM 7 ADDED	C.C.	JUN'14	A.T.	B.C.
12	ITEM 3 REVISED TABLE REVISED NOTE 2 ADDED	GMCK	MAR'93	B.T.K.	N.S.
11	FUSS TUBE DIMENSION REMOVED	GMCK	MAY'91	-	A.T.
10	TITLE AND NUMBER CHANGED FUSE ELEMENT AND TABLE DELETED	GMCK	NOV'87	-	G.S.
NO	DESCRIPTION	DRN	DATE	CKD	APPD
AMENDMENTS					



DES	A.TAYLOR	POWER STANDARD DRAWING			
DRN	C.COPPINS	SWITCHGEAR 22 kV SWITCH FUSE ASSEMBLIES			
CKD	A.TAYLOR				
APPD	A.TAYLOR				
SCALE	N.T.S.				
ISSUED	OCT'10	A3	DRAWING NUMBER	S01-01-06-06	
ALL DIM. IN mm					
DRAFTING STANDARD TO A.S.1100			CAD PRODUCT - DO NOT AMEND MANUALLY		

