

**PLAN**

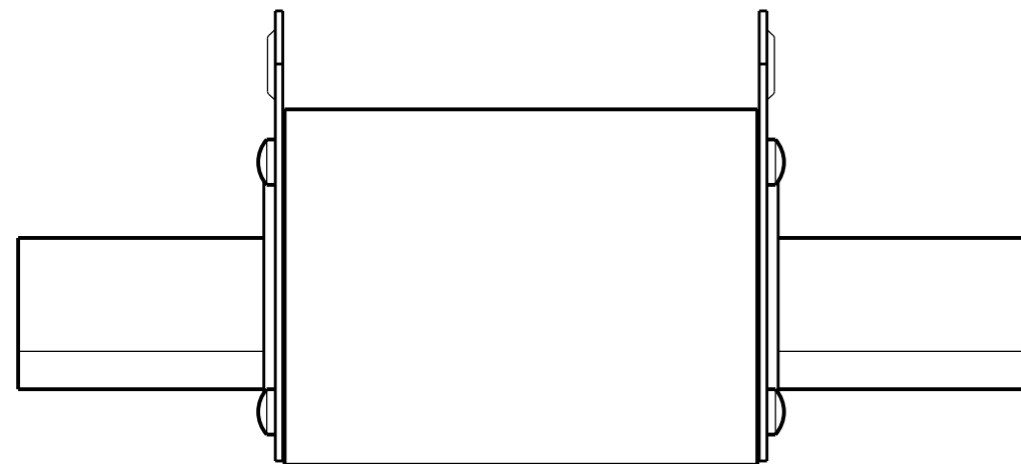

**ELEVATION**

| STRIPLE FUSES |                  |                |      |
|---------------|------------------|----------------|------|
| ITEM          | FUSE ITEM NUMBER | CURRENT RATING | SIZE |
| 11            | 286211           | 63A            | 00   |
| 12            | 26229            | 80A            |      |
| 13            | 286237           | 100A           |      |
| 14            | 286245           | 125A           |      |
| 15            | 205088           | 160A           |      |
| 16            | 157974           | 35A            | 1    |
| 1             | 10058            | 63A            |      |
| 2             | 10066            | 100A           |      |
| 17            | 158162           | 125A           |      |
| 3             | 11064            | 160A           |      |
| 4             | 9712             | 200A           | 2    |
| 5             | 11072            | 250A           |      |
| 6             | 9761             | 315A           |      |
| 7             | 9720             | 355A           | 3    |
| 8             | 9738             | 400A           |      |
| 9             | 9746             | 500A           |      |
| 10            | 9753             | 630A           |      |

| STRIPLE SOLID LINKS |                  |                |      |
|---------------------|------------------|----------------|------|
| ITEM                | LINK ITEM NUMBER | CURRENT RATING | SIZE |
| 18                  | 205070           | 160A           | 00   |
| 19                  | 258210           | 250A           | 1    |
| 20                  | 502716           | 1250A          | 3    |

| SWITCH-FUSE DISCONNECTORS |             |                |      |
|---------------------------|-------------|----------------|------|
| ITEM                      | ITEM NUMBER | CURRENT RATING | SIZE |
| 21                        | 407050      | 160A           | 00   |
| 22                        | 255943      | 400A           | 1    |
| 23                        | 11866       | 630A           | 3    |
| 24                        | 292276      | 1000A          | 3    |

| GENERATOR DISCONNECTORS |             |                |      |
|-------------------------|-------------|----------------|------|
| ITEM                    | ITEM NUMBER | CURRENT RATING | SIZE |
| 25                      | 406808      | 1000A          | 3    |
| 26                      | 406811      | 2000A          | 3    |

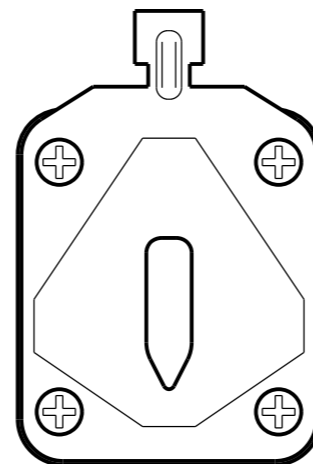

**END ELEVATION**

DIN 43-620 FUSE EXAMPLE

**NOTES:**

- NOMINAL VOLTAGE 500V AC.
- FUSE RATED SHORT CIRCUIT BREAKING CAPACITY 120 kA (IEC 60947-2)
- FUSE SPEED TO BE 'FAST ACTING'
- FUSE UTILISATION CATEGORY TO BE gG
- SIZES TO BE IN ACCORDANCE WITH DIN 43-620
- INSULATED EXTRACTION TAGS ARE NOT ACCEPTABLE
- REFER TO POWER AND WATER STANDARD DRAWINGS S02-01-04-08, S02-01-04-11, S02-01-04-17 & S04-01-03-05 FOR SWITCH-FUSE ASSEMBLIES.
- SIZE 2 FUSES MAY BE USED IN SIZE 3 ASSEMBLIES.

| NO | DESCRIPTION  | DRN  | DATE   | CKD    | APPD |
|----|--|------|--------|--------|------|
| 14 | ADDED TABLES FOR SOLID LINKS, SWITCH-FUSE & GENERATOR DISCONNECTORS<br>ADDED SOLID LINKS TO TITLE. EXPANDED NOTE 7 & ADDED NOTE 8. | A.N. | MAR'21 | C.C.C. | B.V. |
| 13 | TITLEBLOCK & DRAWING NUMBER FORMATTED  | K.T. | FEB'19 | C.C.   | C.C. |
| 12 | SIZE 00 STOCK CODES ADDED  | A.T. | APR'12 | B.C.   | S.C. |
| 11 | TABLE AND TECHNICAL DATA AMENDED   | A.S. | DEC'04 | R.C.   | C.C. |
| 10 | JEAN MULLER ITEM ADDED, TITLE CHANGED.   | RG1  | APR'01 | MB     | FRR  |
| 9  | TECHNICAL DATA ADDED.  | -    | -      | -      | MCA  |
| 8  | TITLE AND DRAWING NUMBER CHANGED.  | -    | MAY'88 | -      | OLT  |



| DES                           | K.CHITT  | POWER STANDARD DRAWING   |                |              |
|-------------------------------|----------|--|----------------|--------------|
| DRN                           | B.TOLSON | <b>FUSES AND SWITCHGEAR<br/>CARTRIDGE<br/>STRIPLE FUSE LINKS &amp; SOLID LINKS</b> |                |              |
| CKD                           | R.HAIGH  |  |                |              |
| APPD                          | K.CHITT  |  |                |              |
| SCALE                         | N.T.S.   |  |                |              |
| ISSUED                        | NOV'82   | A3   | DRAWING NUMBER | S02-01-04-10 |
| ALL DIM.                      | IN mm    |  |                |              |
| DRAFTING STANDARD TO A.S.1100 |          | CAD PRODUCT - DO NOT AMEND MANUALLY  |                |              |