

D

E

SYSTEM VOLTAGE 22 kV
 RATED CONTINUOUS CURRENT 250 A
 ACTUATING CURRENT 40 A
 NUMBER OF FAULT COUNTS 2
 RESET (RECLAIM) TIME 30 SECS
 DEADLINE DETECTOR 0.3 A FOR 0.1 SEC
 RESPONSE TIME OF CURRENT DETECTING ELEMENT 0.05 SEC
 LIGHTNING IMPULSE LEVEL 150 kVp

E

NOTES :

1. SECTIONALISER AND ACTUATOR TO BE IN ACCORDANCE WITH P.A.W.A. STANDARD SPECIFICATION STS-023.
2. SECTIONALISER IS TO BE COMPATIBLE WITH SWITCH FUSE ASSEMBLY (ITEM 1 ON DRG S01-01-06-06) AND TRI-FUSE ASSEMBLY (ITEM 1 ON DRAWING S1-1-6-3)

ITEM	DESCRIPTION	STOCK CODE
1	AUTOMATIC ELECTRONIC SECTIONALISER	283887
2	ACTUATOR	283895

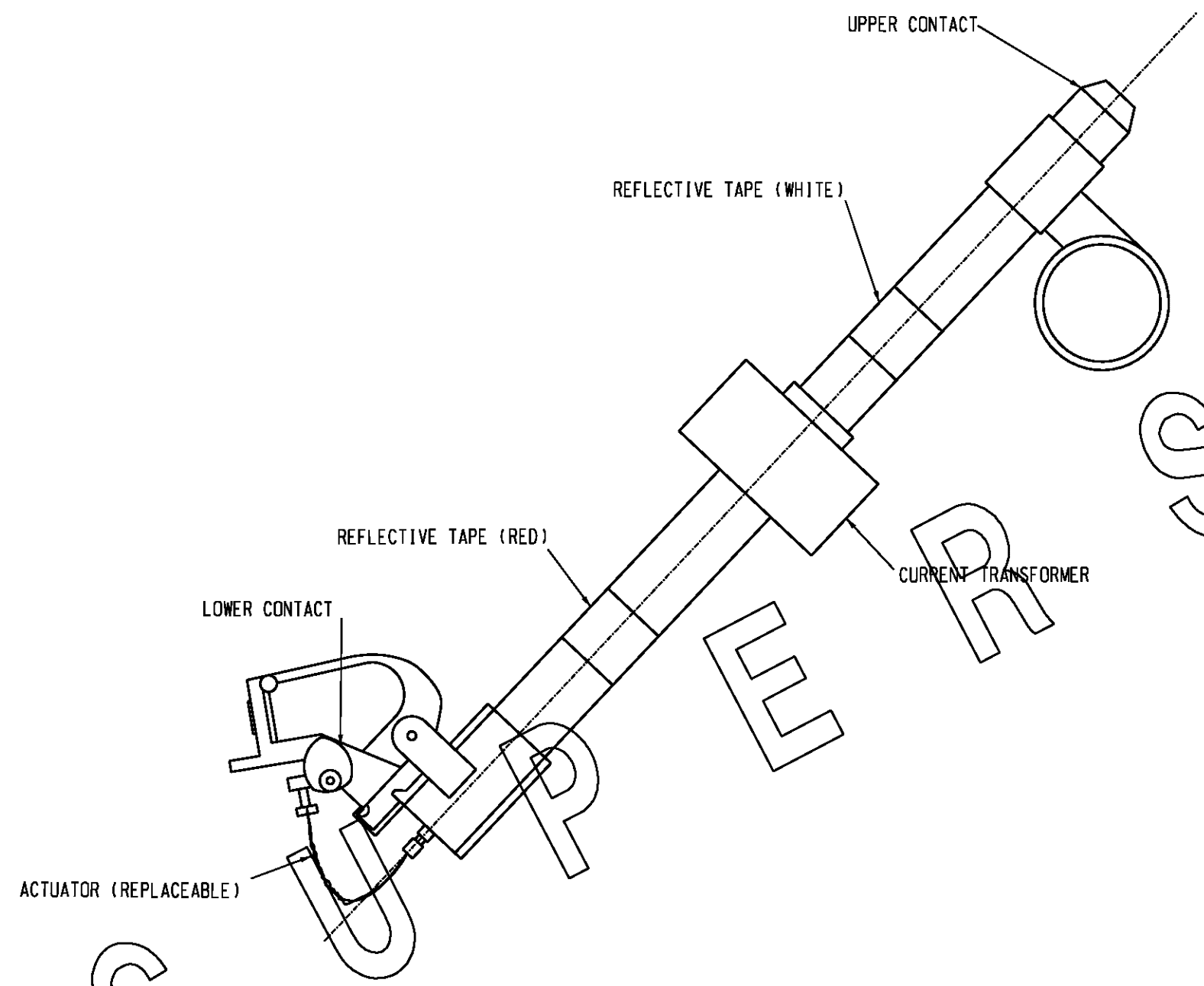

S

NO	DESCRIPTION	DRN	DATE	CKD	APPD
1	DRAWING SUPERSEDED BY S01-01-06-14	A.S.	24.1.06	C.C.	C.C.
AMENDMENTS					

PowerWater
NORTHERN TERRITORY

DES	A.T.	POWER STANDARD DRAWING		
DRN	J.A.L.	SWITCHGEAR AUTOMATIC ELECTRONIC SECTIONALISER AND ACTUATOR		
CKD	S.C.M.			
APPD	P.J.D.			
SCALE	1:2			
ISSUED	JUL '95	A3	DRAWING NUMBER	S01-01-06-12
ALL DIM. IN mm				
DRAFTING STANDARD TO A.S.1100			CAD PRODUCT - DO NOT AMEND MANUALLY	



AMDT