

FRONT VIEW WISHBONE CONSTRUCTION
 1:20 MATERIAL : 125 x 75 x 4 RHS
 MAXIMUM DEVIATION = 22°
 ITEM NUMBER 402038

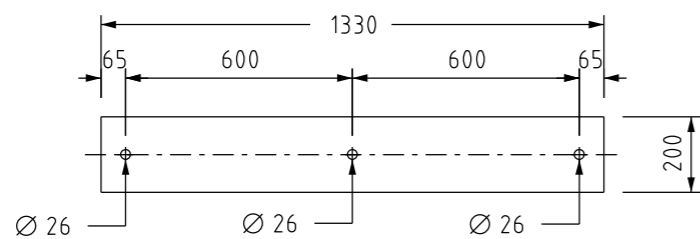

FRONT VIEW MOUNTING PLATE
 1:20 MATERIAL : 200 x 12 THICK, 1330 LONG PL

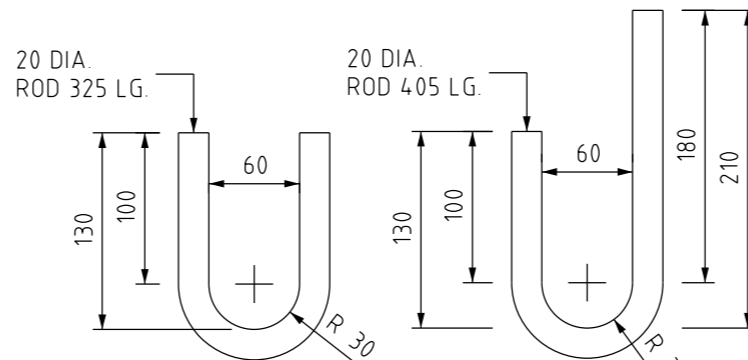

FRONT VIEW U-BENDS
 1:5

SEE NOTES FOR WELD DETAIL

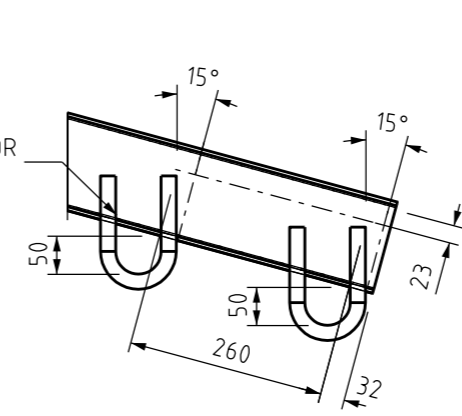

DETAIL A
 1:10

SEE NOTES FOR WELD DETAIL

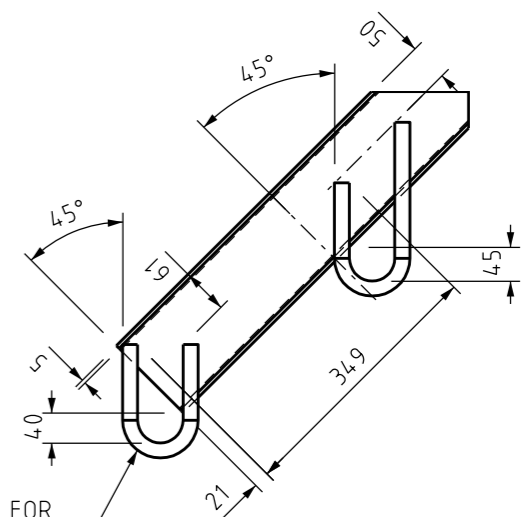

DETAIL B
 1:10

SEE NOTES FOR WELD DETAIL

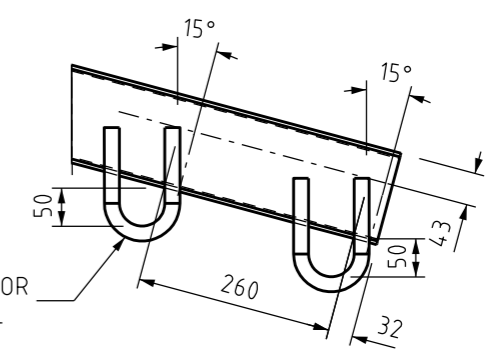

DETAIL C
 1:10

WISHBONE CONSTRUCTION NOTES:

1. ALL WELDS TO BE 6mm FILLET U.N.O.
2. ALL WORKMANSHIP AND MATERIALS SHALL BE IN ACCORDANCE WITH AS 3678 & POWERWATER SPECIFICATION STSP 01-002
3. ALL WELDING AND WELD PREPARATION SHALL BE IN ACCORDANCE WITH AS 1554. FILLET WELDS TO BE 6MM UNLESS NOTED OTHERWISE.
4. ALL ROUGH OR BURRED EDGES ARE TO BE DRESSED CLEAN.

0	DETAILS TRANSFERRED FROM S01-02-01-46 FABRICATION NOTE 2 EDITED. DIMENSIONS INCLUDING U-BEND DETAILS AMENDED.	C.C.	JUL'21	B.V.	A.N.
NO	DESCRIPTION	DRN	DATE	CKD	APPD
AMENDMENTS					



DES M. BOCK		POWER STANDARD DRAWING	
DRN C. COPPINS		CROSSARM 22kV WISHBONE ARRANGEMENT FOR UNIVERSAL POLE CONSTRUCTION	
CKD M. BOCK			
APPD C. PEMBERTON			
SCALE AS SHOWN		A3	DRAWING NUMBER S01-01-02-22
ISSUED JULY 2021			
ALL DIM. IN mm		CAD PRODUCT - DO NOT AMEND MANUALLY	
DRAFTING STANDARD TO A.S.1100		AMDT	