

**THREE TRANSFORMER SUBSTATION
MINIMUM SIZE 12500 X 7200
INTERNAL DIMENSIONS**

NOTES

1. FOR CONDUIT SCHEDULE AND ASSOCIATED REFERENCE DRAWINGS REFER DRAWING No. S02-2-7-40.
2. ADDITIONAL STEPS (UP TO A MAXIMUM OF 3) INCLUDING AN APPROPRIATE HANDRAIL MAY BE PROVIDED AT ANY PERSONNEL DOORWAY. IF THE STEPS ARE TO BE LOCATED WITHIN THE SUBSTATION CHAMBERS, IT WILL BE NECESSARY TO EXTEND THE SUBSTATION CHAMBER TO ACCOMMODATE THE ENCROACHMENT OF THE STEPS, SUCH THAT THE INTERNAL DIMENSIONS OF THE SUBSTATION CHAMBER ARE NOT REDUCED.
3. SUBSTATION DIMENSINS WILL VARY DEPENDING ON THE LOCATION IN WHICH EQUIPMENT IS INSTALLED. THROUGHT OUT THE SUBSTATION CHAMBER A MINIMUM OF 1000mm CLEAR OPENING SHALL BE PROVIDED FROM ANY STRUCTURE TO EQUIPMENT AND 900mm BETWEEN EQUIPMENT.

LEGEND

- RAISED FLOOR LINE
-  RAISED FLOOR AREA (100mm)

PLAN VIEW
SCALE 1:50

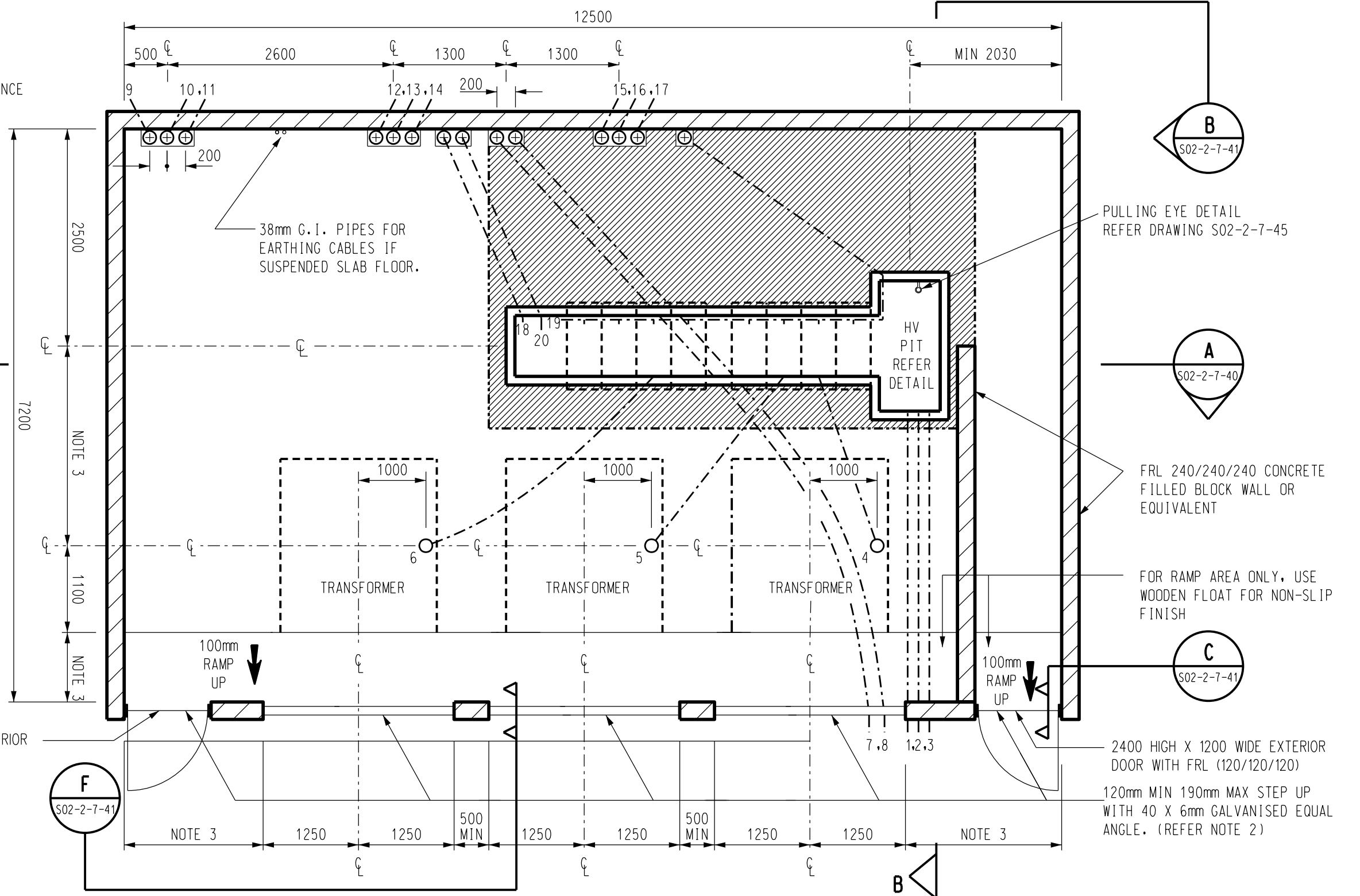

NO	DESCRIPTION	DRN	DATE	CKD	APPD
3	DIMENSIONS AMENDED	A.B.	JAN'17	I.B.	B.C.
2	NOTE 3 ADDED, DIMENSIONS UPDATED, DOORS UPDATED	A.T.	JUN'14	B.C.	B.C.
1	UPDATE DOOR SWING	K.I.	SEP'06	R.S.	S.C.
AMENDMENTS					



DES	I. PURVES	POWER STANDARD DRAWING		
DRN	G.R./A.D.	THREE TRANSFORMER INDOOR SUBSTATION SURFACE CHAMBER - OPTION 2 CONSTRUCTION DETAILS SHEET 1 of 3		
CKD	S. LEACH			
APPD	F. ROBSON	A3	DRAWING NUMBER	S02-2-7-39
SCALE	AS SHOWN			
ISSUED	MARCH'98	3 AMDT		
ALL DIM.	IN mm			
DRAFTING STANDARD TO A.S.1100		CAD PRODUCT - DO NOT AMEND MANUALLY		