

FOR POTABLE WATER ONLY

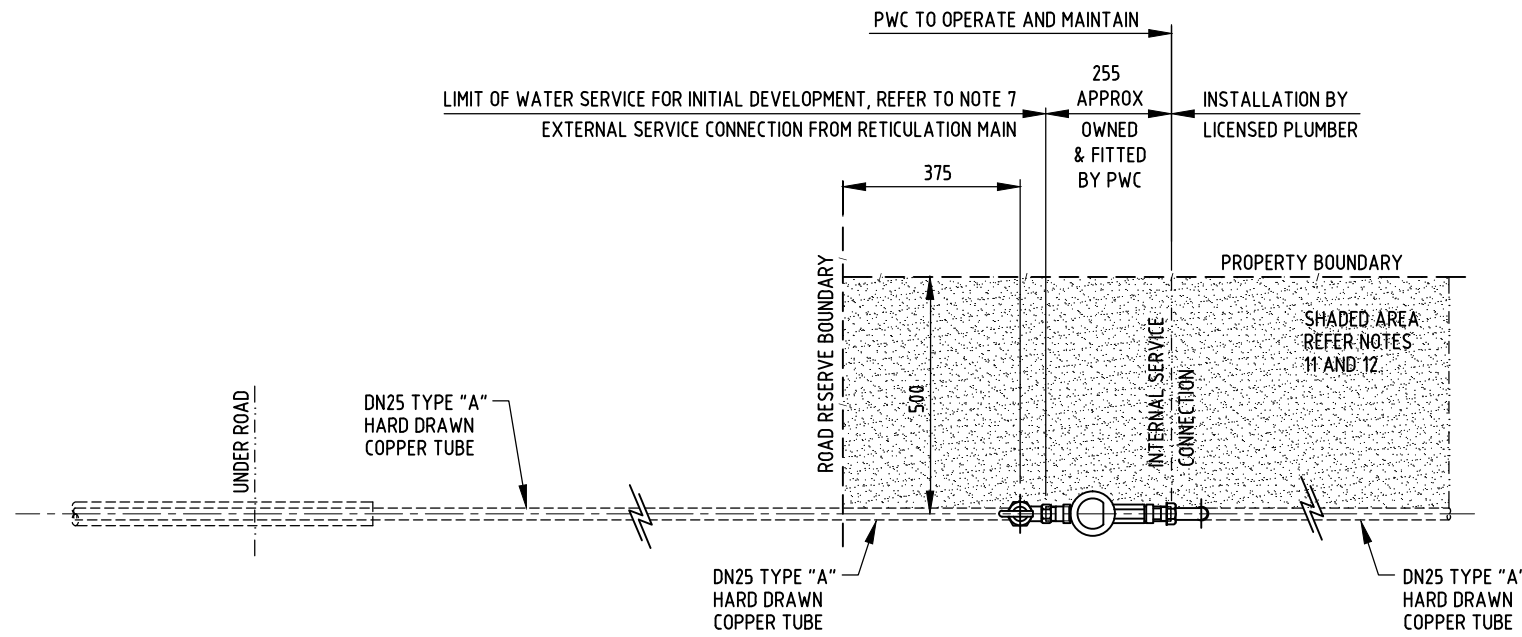

PLAN

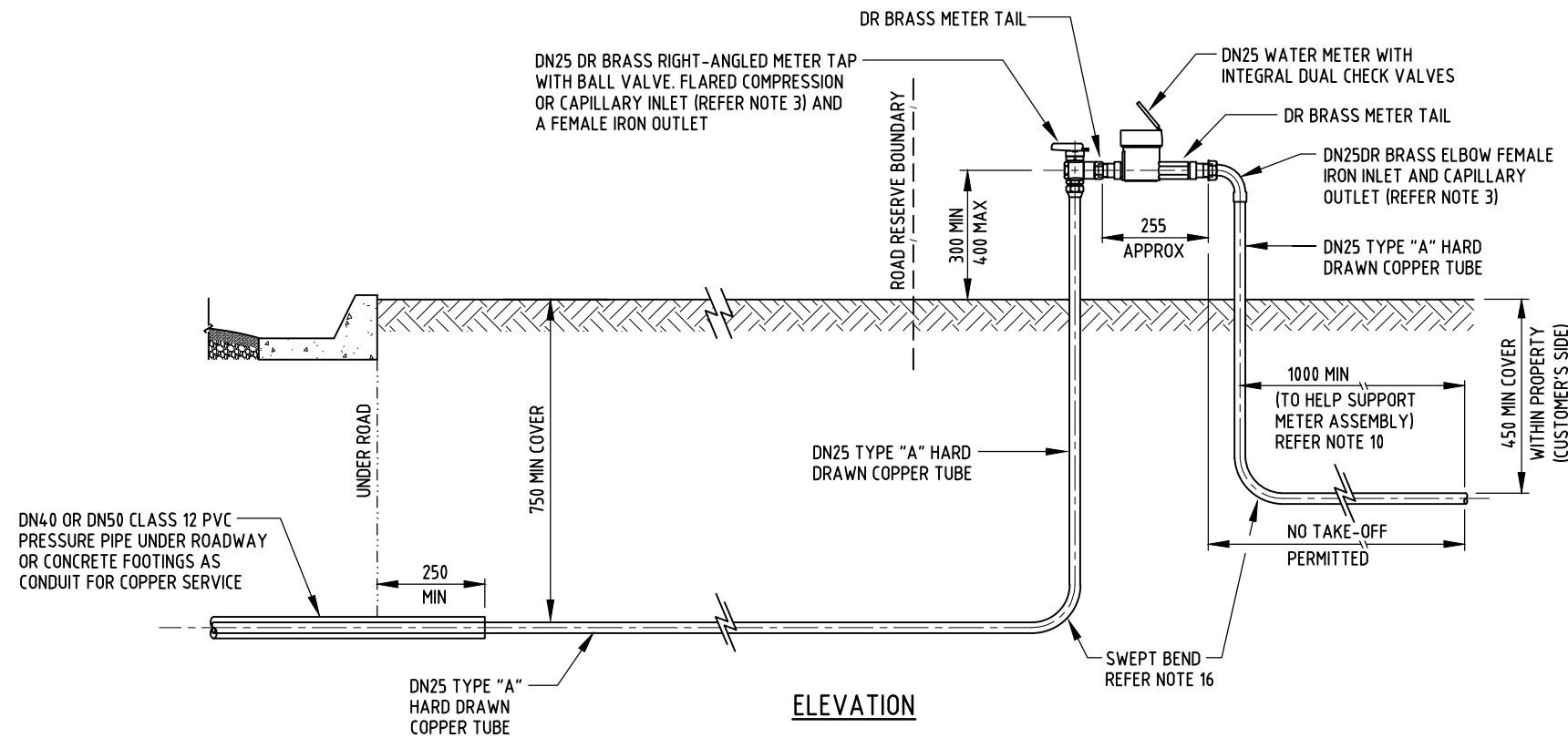

ELEVATION

NOTES:

1. ALL DIMENSIONS IN MILLIMETRES UNLESS NOTED OTHERWISE.
2. COPPER ALLOY SHALL BE DEZINCIFICATION RESISTANT (DR) TO AS2345.
3. USE SILVER BRAZING ALLOY (MIN 2% SILVER TO AS1167.1) FOR ALL CAPILLARY JOINTING OF COPPER PIPES AND FITTINGS OR ALTERNATIVELY, FOR HORIZONTAL JOINTS ABOVE GROUND PRESS FITTINGS MAY BE USED.
4. THE METER ASSEMBLY SHALL BE HORIZONTAL.
5. ONLY PWC (OR ITS AUTHORISED CONTRACTORS) ARE PERMITTED TO TAP EXISTING, IN-SERVICE (LIVE) MAINS OR MAINS THAT HAVE BEEN HYDROSTATICALLY TESTED. WITHIN LICENSED AREAS AND UPON PAYMENT OF THE NECESSARY FEES, PWC WILL PERFORM TAPPING OF LIVE MAINS, HOWEVER, EXCAVATION, ALL MATERIALS AND INSTALLATION SHALL BE SUPPLIED BY THE CONTRACTOR.
6. ALL PIPES, VALVES AND FITTINGS MUST BE WATER MARK APPROVED.
7. ON COMPLETION OF WATER SERVICE, PROVIDE BRASS PLUG FITTED TO METER TAP OUTLET.
8. NON-METALLIC MATERIALS AND FITTINGS SHALL NOT FORM PART OF WATER METER ASSEMBLY.
9. BACKFLOW CERTIFIED PLUMBER IS REQUIRED TO DETERMINE THE RISK OF CONTAMINATION OF THE POTABLE WATER SUPPLY DUE TO CROSS CONNECTIONS, REFER AS/NZS3500.1. A TESTABLE BACKFLOW PREVENTION DEVICE SHALL BE FITTED FOR MEDIUM OR HIGH HAZARD PROPERTIES.
10. TO ENSURE INTEGRITY AND STABILITY OF THE WATER METER INSTALLATION ANY CONNECTION TO THE COPPER RISER OF THE CUSTOMER'S SERVICE AND THE FIRST UNDERGROUND 1000mm OF THE CUSTOMER'S SERVICE MUST USE BRAZED JOINTS COMPLYING WITH NOTE 3.
11. NO OTHER UTILITY SERVICES (EG. COMMUNICATIONS, POWER, SEWER) TO BE INSTALLED BETWEEN WATER METER AND PROPERTY BOUNDARY.
12. MINIMUM CLEARANCE TO OTHER SERVICES SHALL BE 300mm.
13. WHERE SIDE BOUNDARY OF PROPERTY ADJACENT TO WATER METER IS NOT PERPENDICULAR TO ROAD RESERVE BOUNDARY, INSTALL WATER METER PARALLEL TO SIDE BOUNDARY.
14. NUT AND TAILS FOR METER INSTALLATION SUPPLIED BY PWC.
15. PRESSURE TEST WATER SERVICE AT 1000kPa FOR 30 MINUTES (NO PRESSURE LOSS PERMITTED) USING WATER CHLORINATED TO A MINIMUM CHLORINE CONCENTRATION OF 25mg/L (REFER PWC WATER SERVICES GUIDELINE FOR DISINFECTION OF SUBDIVISIONS AND WATER SERVICE CONNECTIONS FROM 20mm AND GREATER). ENSURE PIPEWORK IS FLUSHED OUT AFTER THE TEST FOR A MINIMUM OF FIVE MINUTES.
16. SWEPT BEND TO BE FORMED USING PIPE BENDER OR BENDING SPRING WITH A BEND RADIUS GREATER THAN FIVE TIMES THE OUTSIDE DIAMETER OF THE COPPER TUBE.
17. REFER TO BUILDING CODE OF AUSTRALIA WHERE A FIRE HOSE REEL IS CONNECTED.
18. NOT TO BE USED WITH FIRE SPRINKLERS OR FIRE HYDRANTS.
19. WHERE A CONCRETE PATH OR SLAB IS CAST UNDER THE METER, PROVIDE A BREAK-OUT SECTION BETWEEN 600x300 AND 1500x600 FOR FUTURE ACCESS TO BURIED PIPEWORK.

2	GENERAL AMENDMENTS 2020.	PW	JULY'20	JR	DC
1	GENERAL UPDATE.	AW	JUNE'18	JR	DC
0	ISSUED FOR INFORMATION.	AW	APRIL'13	RJ	RJ
NO	DESCRIPTION	DRN	DATE	CKD	APPD
AMENDMENTS					



DES	-	WATER STANDARD DRAWING		
DRN	AW	SERVICES		
CHK	RJ	DN25 WATER SERVICE - COPPER		
APPD	RJ	LOW HAZARD		
SCALE	N.T.S.	A3	DRAWING NUMBER	W1-1-02A
ISSUED	APRIL 2013			2
ALL DIM. IN mm		CAD PRODUCT - DO NOT AMEND MANUALLY		AMDT
DRAFTING STANDARD TO A.S.1100				