

ITEM 1 LV LINE, 4 WIRE SUPERSEDED BY S01-1-2-11
 STOCK CODE 9589 LV-LINE, 4 WIRE

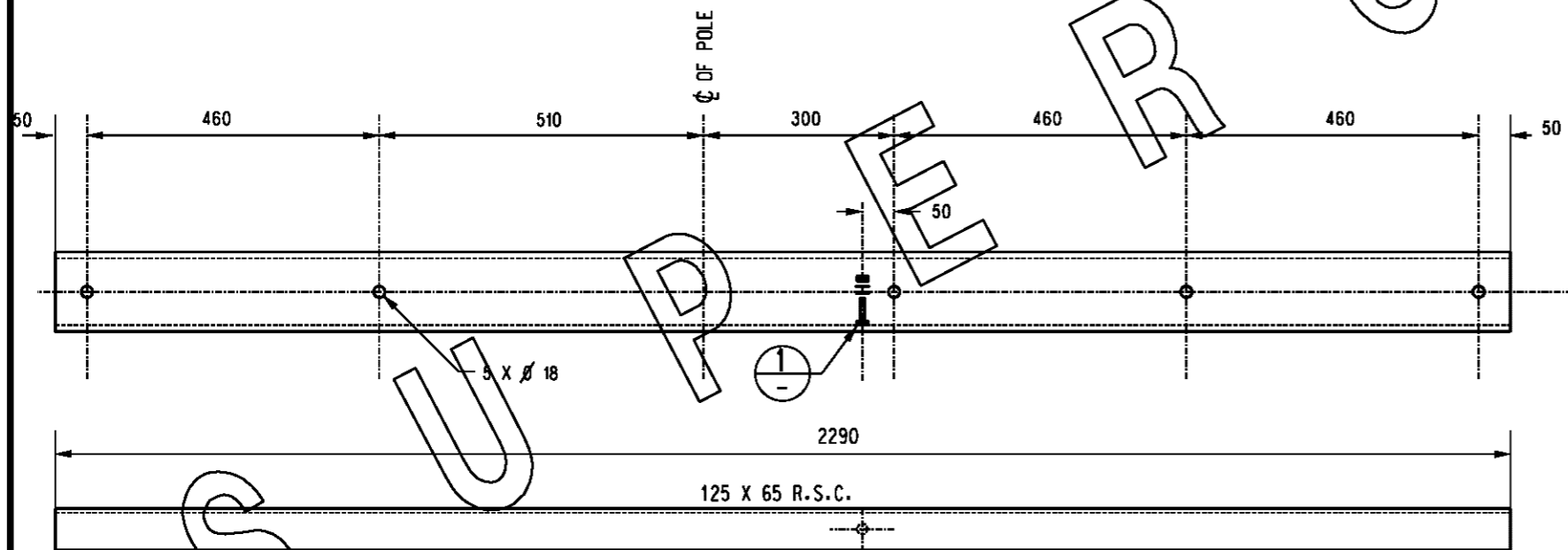

ITEM 2 LV-LINE, 5 WIRE SUPERSEDED BY S01-1-2-20
 STOCK CODE 9571 LV-LINE, 5 WIRE

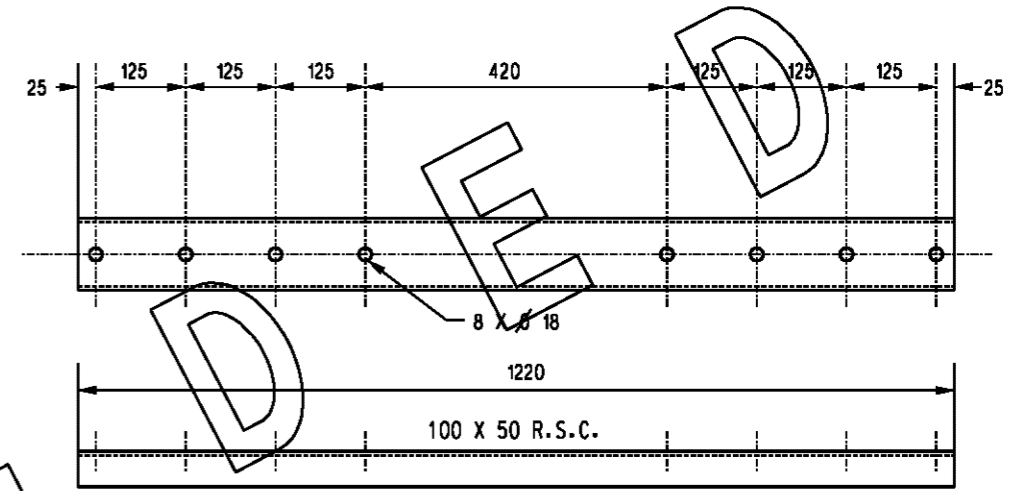

ITEM 3 CROSSARM-SERVICE
 STOCK CODE 9555
 SUPERSEDED BY S01-1-2-11
 LV-SERVICE

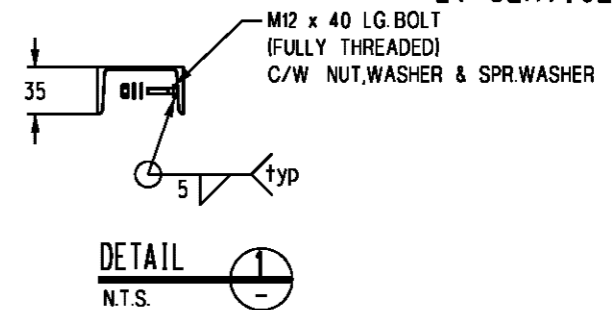

STEELWORK NOTES :

1. ALL WORKMANSHIP AND MATERIALS SHALL BE IN ACCORDANCE WITH AS1204.
2. ALL WELDING AND WELD PREPARATION SHALL BE IN ACCORDANCE WITH AS1554.
3. ALL ROUGH OR BURRED EDGES ARE TO BE DRESSED CLEAN.
4. BOLTS TO BE METRIC PROPERTY CLASS 4.6 AND SHALL BE IN ACCORDANCE WITH AS1111.

9	SUPERSEDED DRAWING	K. I.	-	B. C.	MAY '06
8	REDRAW ON MICROSTATION.	J. A. L.	-	F. R. R.	JUN '98
7	REDRAWN, TRANSFORMER AND TERM. CROSSARM REMOVED ANS DRAWN ON S1-1-2-5.	G. L.	-	N. S.	MAY '91
NO	DESCRIPTION	DRN	DATE	CKD	APPD
AMENDMENTS					

PowerWater
 NORTHERN TERRITORY

DES	.	POWER STANDARD DRAWING			
DRN	G. L.	CROSSARMS STEEL L.V.			
CKD	gmck/N. S.				
APPD	B. KENT				
SCALE	1:10				
ISSUED	MAY '91	A3	DRAWING NUMBER	S01-01-02-01	9 AMDT
ALL DIM.	IN mm	DRAWING NUMBER		S01-01-02-01	
DRAFTING STANDARD TO A.S.1100			CAD PRODUCT - DO NOT AMEND MANUALLY		