

ISOMETRIC VIEW

SINGLE CORE CABLE CLEATS
REFER S02-01-09-03

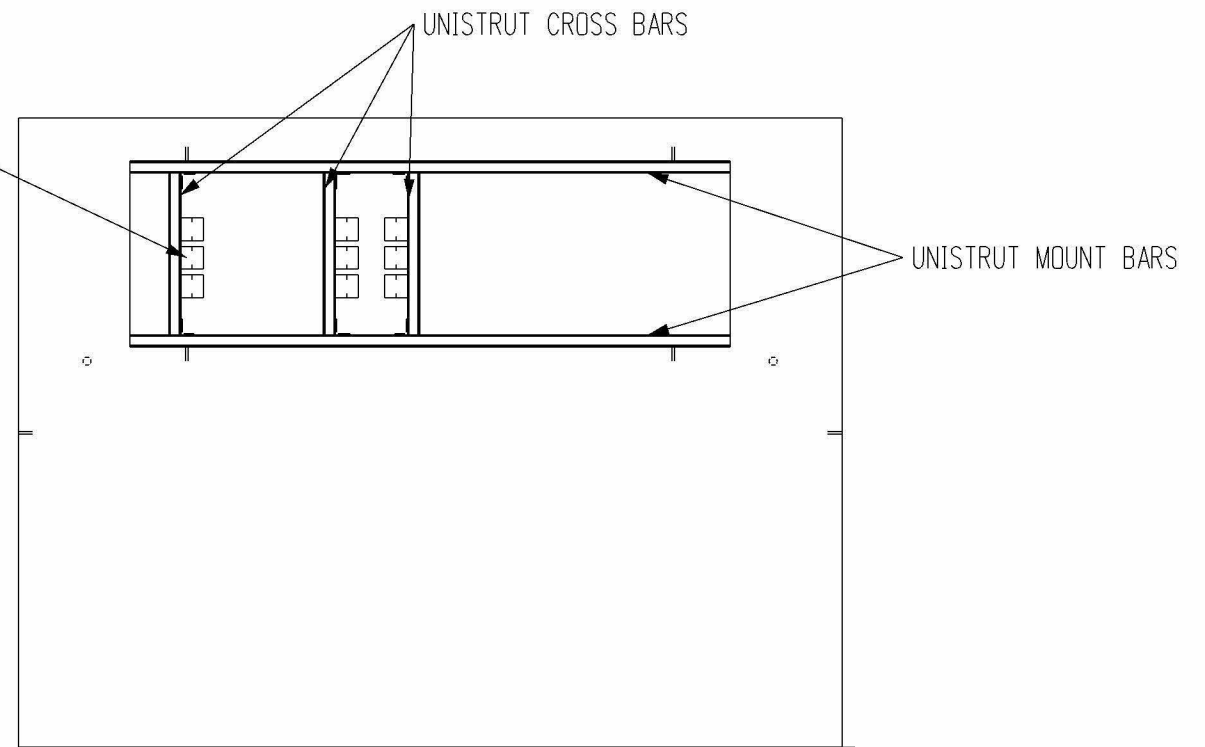

TOP VIEW

NOTES:

1. FOUNDATION SHOWN IS FOR A 4 WAY (KTK) MK2 SUBSTATION, HOWEVER CLAMPING ARRANGEMENT ALSO APPLIES TO STAND ALONE DRIESCHER RMUS
2. UNISTRUT CROSS BARS AND CABLE CLEATS ARE IN INDICATIVE POSITIONS ONLY ACTUAL POSITIONS WILL BE DETERMINED BY SWITCHGEAR TYPE AND CABLE SIZES.
3. UNISTRUT MOUNT BARS CAN BE CUT BACK BEYOND THE BOLTS SECURING THEM TO THE FOUNDATION AS REQUIRED.
4. ALL UNISTRUT BARS ARE P1000 CHANNEL.
5. CONNECT UNISTRUT CROSS BARS TO MOUNTING BARS WITH UNISTRUT P1026 ANGLE PLATES AND P1010 SPRING NUTS
6. ALL UNISTRUT ITEMS AND BOLTS SHALL BE HOT DIPPED GALVANIZED.
7. ALL CABLE CLEATS SHALL BE PWC APPROVED ITEMS. REFER TO S02-01-09-03.

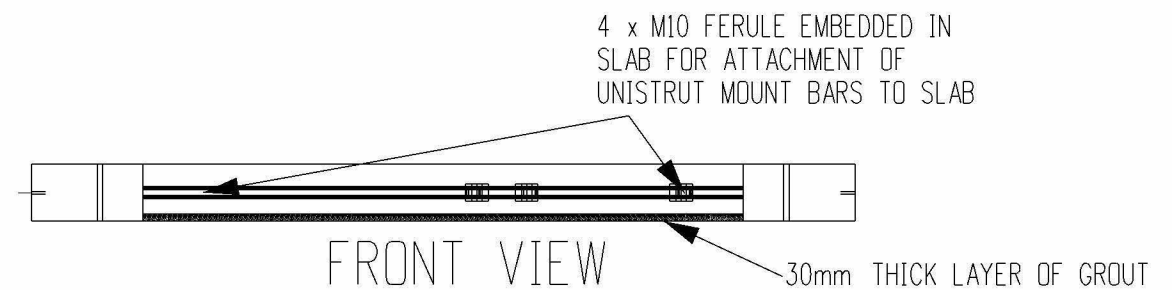

FRONT VIEW

						DES A.T.		POWER STANDARD DRAWING	
						DRN A.T.		CIVIL, CABLE CLAMPING ARRANGMENTS IN FOUNDATION SLABS	
						CKD B.C.			
						APPD B.C.			
						SCALE 1:25			
						ISSUED MAY'14		A3	DRAWING NUMBER S02-02-06-36
						ALL DIM. IN mm			
						DRAFTING STANDARD TO A.S.1100		CAD PRODUCT - DO NOT AMEND MANUALLY	
								AMDT	

2	TITLEBLOCK & DRAWING NUMBER FORMATTED	K.T.	FEB'19	C.C.	C.C.
1	NOTE 7 ADDED	A.T.	JAN'15	B.C.	B.C.
0	ISSUED FOR CONSTRUCTION	A.T.	MAY'14	B.C.	B.C.
NO	DESCRIPTION	DRN	DATE	CKD	APPD
AMENDMENTS					

