

ALL CONDUITS ASSUMED TO BE HEAVY DUTY ORANGE
 1. 15x 100mm ϕ CONDUITS - O.D. 114.2
 2. 1x 80mm ϕ CONDUITS - O.D. 89.0
 3. 2x 20mm ϕ CONDUITS - O.D. 20.0
 4. 1x 70mm² BARE COPPER EARTH CONDUCTOR
 NB.: CONDUIT DIMENSIONS ARE NOMINAL

COMMENTS

- JIG DESIGN IS TO BE USED FOR CONCRETE SLAB S02-2-6-41 ONLY
- 3000 x 1000 mm FRAME SIZE RECOMMENDATION ONLY
- RECOMMEND CONDUIT APERTURE TO BE ADJUSTABLE
- APERTURE SIZES ①, ②, ③, & ④ ARE RECOMMENDATIONS ONLY
- FRAME MATERIAL & ASSEMBLY IS TO BE CHOICE OF CONTRACTOR & THEIR REQUIREMENTS.
- JIG SHOULD INCORPORATE FIXING POINTS IN ORDER TO ACCURATELY & SECURELY FIX IN DESIRED POSITION.

NO	DESCRIPTION	NO	DESCRIPTION	DRN	DATE	CKD	APPD
S02-2-6-37	Civil, Mk3 Package Substn Greenfield Cable Entry & Foundation Detail						
S02-2-6-37	Civil, Mk3 Package Substn Cable Entry & Foundation Detail						
S02-2-6-36	Civil, Clamping Arrangement in Foundation Slabs						
S02-2-6-33	Ground Level Details Package Substn & RMU						
S02-2-6-18	Mk3 Package Substn Electrical Drawings						
S02-2-6-17	Civil Substn Easement Details HV & LV Equipment	1	DIMENSION CORRECTION	CWM	AUG'18	IB	B.VDS
S02-2-6-10	Earthing Package Substn Mk2 Construction Details	0	ISSUED FOR CONSTRUCTION	CWM	SEP'17	B.VDS	B.C
REFERENCE DRAWINGS & DOCUMENTS		AMENDMENTS					



DES	B.VDS	POWER STANDARD DRAWING			
DRN	CWM	MARK 3 PACKAGE SUBSTATION CONDUIT LOCATION JIG WITH MARK 3 CONCRETE SLAB (SHEET 1 OF 2)			
CKD	I.B.				
APPD	B.C.				
SCALE	N.T.S.				
ISSUED	SEP'17	A3	DRAWING NUMBER	S02-2-6-40_1	
ALL DIM. IN mm					
DRAFTING STANDARD TO A.S.1100		CAD PRODUCT - DO NOT AMEND MANUALLY		AMDT	

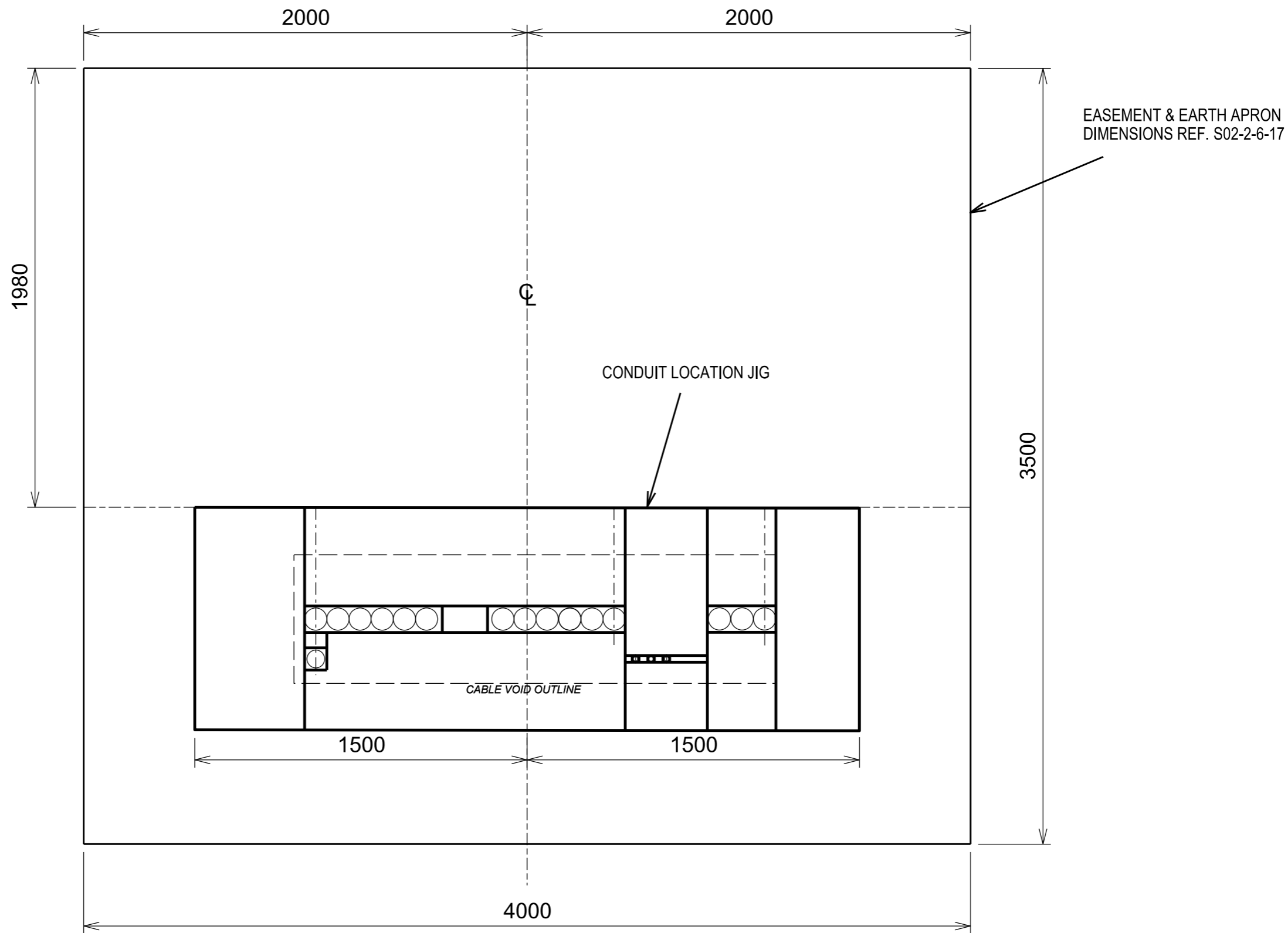

NO	DESCRIPTION
S02-2-6-37	Civil, Mk3 Package Substn Greenfield Cable Entry & Foundation Detail
S02-2-6-37	Civil, Mk3 Package Substn Cable Entry & Foundation Detail
S02-2-6-36	Civil, Clamping Arrangement in Foundation Slabs
S02-2-6-33	Ground Level Details Package Substn & RMU
S02-2-6-18	Mk3 Package Substn Electrical Drawings
S02-2-6-17	Civil Substn Easement Details HV & LV Equipment
S02-2-6-10	Earthing Package Substn Mk2 Construction Details

NO	DESCRIPTION	DRN	DATE	CKD	APPD
1	SHEET 1 AMENDED	CWM	AUG' 18	I. B.	B. VDS
0	ISSUED FOR COMMENT	CWM	APR' 17	B. VDS	B. C

PowerWater
 NORTHERN TERRITORY

DES	B. VDS	POWER STANDARD DRAWING		
DRN	CWM	MARK 3 PACKAGE SUBSTATION CONDUIT LOCATION JIG SETUP & POSITION WITH MARK 3 CONCRETE SLAB SHEET 2 OF 2		
CKD	I. B.			
APPD	B. C.			
SCALE	N. T. S.			
ISSUED	APR' 17	A3	DRAWING NUMBER	S02-2-6-40_2
ALL DIM.	IN mm			
DRAFTING STANDARD TO A.S.1100		CAD PRODUCT - DO NOT AMEND MANUALLY		AMDT