

PLAN

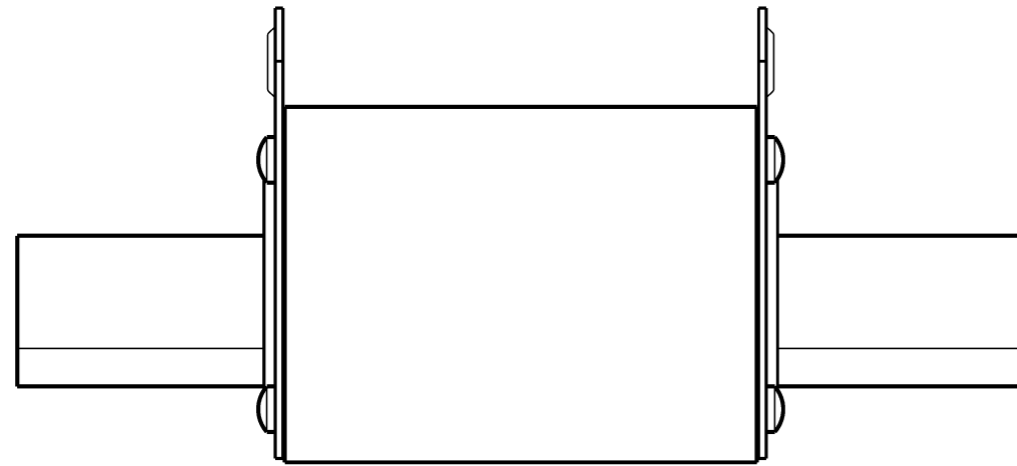

ELEVATION

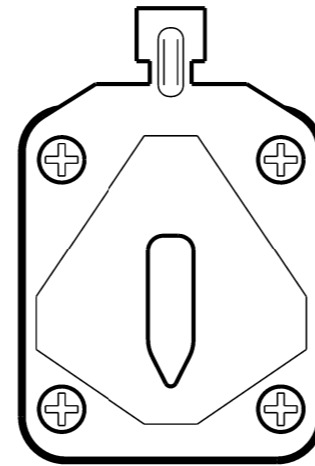

END ELEVATION

ITEM	STOCK CODE	CURRENT RATING	SIZE	JEAN MULLER	ALSTOM
1	10058	63A	1		NHG00-065
2	10066	100A	1		NHG00-100
3	11064	160A	1		NHG00-160
4	9712	200A	1		NHG1-200
5	11072	250A	1		NHG2-250
6	9761	315A	2		NHG2-315
7	9720	355A	2		NHG2-355
8	9738	400A	2		NHG2-400
9	9746	500A	3		NHG3-500
10	9753	630A	3		NHG3-630

TECHNICAL DATA

VOLTAGE - 500v AC 120kA
 ACCORDING TO DIN43-620 & IEC 60269 - 2

FAST ACTING

FUSES MUST COMPLY WITH AS 2005.1

INSULATED EXTRACTION TAGS NOT ACCEPTABLE.

REFER DRGS: S2-1-4-8, S2-1-4-11.

11 TABLE AND TECHNICAL DATA AMENDED 10 JEAN MULLER ITEM ADDED, TITLE CHANGED. 9 TECHNICAL DATA ADDED. 8 TITLE AND DRAWING NUMBER CHANGED.						DES	K.CHITT	POWER STANDARD DRAWING		
						DRN	B.TOLSON	FUSES AND SWITCHGEAR CARTRIDGE STRIPLE FUSE 63A - 630A		
						CKD	R.HAIGH			
						APPD	K.CHITT			
						SCALE	1:1	A3	DRAWING NUMBER	S2-1-4-10
				ISSUED	NOV'82					
AMENDMENTS				DRN	DATE	CKD	APPD	DRAFTING STANDARD TO A.S.1100		

