

FUSE SELECTION TABLE FOR 400A ISOLATING FUSE SWITCH

STOCK CODE	FUSE RATING	FUSE MOUNTING DIMENSIONS
119552	63A	
247544	80A	
1313	100A	
1347	125A	
1354	160A	
1370	200A	
1388	250A	
1420	315A	
1438	400A	

FUSE SELECTION TABLE FOR 800A ISOLATING FUSE SWITCH

STOCK CODE	FUSE RATING	FUSE MOUNTING DIMENSIONS
1404	315A	
1321	355A	
1339	400A	
1362	450A	
1396	500A	
1412	630A	
1446	710A	
1461	800A	

NOTES

1. SWITCHES TO COMPLY WITH AS3947.3.
2. INSULATORS TO COMPLY WITH AS3608.
3. STEEL MATERIAL TO COMPLY WITH AS3678, GRADE 250.
4. HOT DIPPED GALVANIZING TO COMPLY WITH AS1650.
5. BOLTS TO BE METRIC STAINLESS STEEL.
6. SWITCH BLADE TO BE COPPER-TINNED.
7. CONTACTS TO BE SILVER/SILVER PLATED.
8. TERMINAL PALMS TO BE COPPER-TINNED.

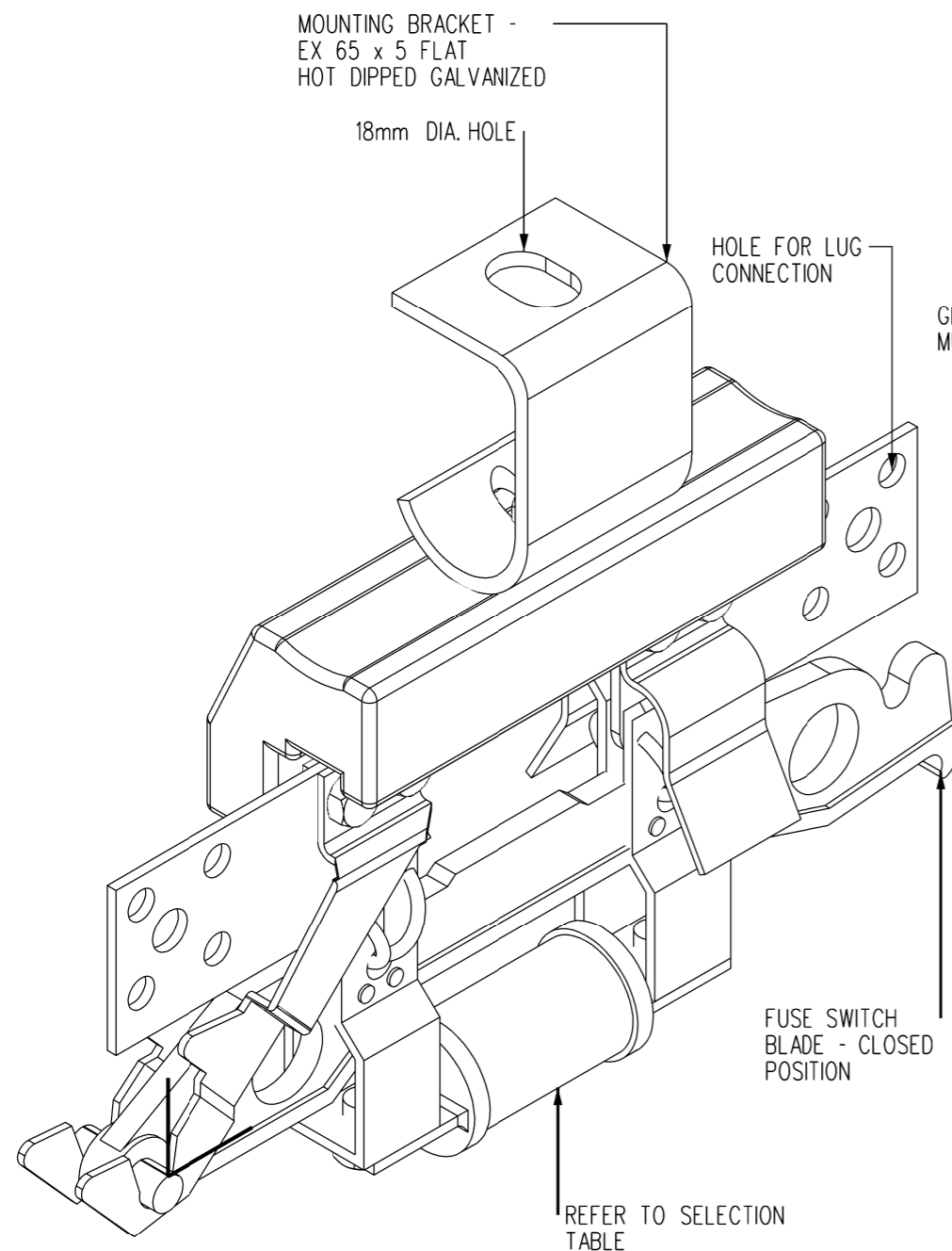

ITEM 1 - LV ISOLATING FUSE SWITCH (400A)

(Stock Code - 2220)

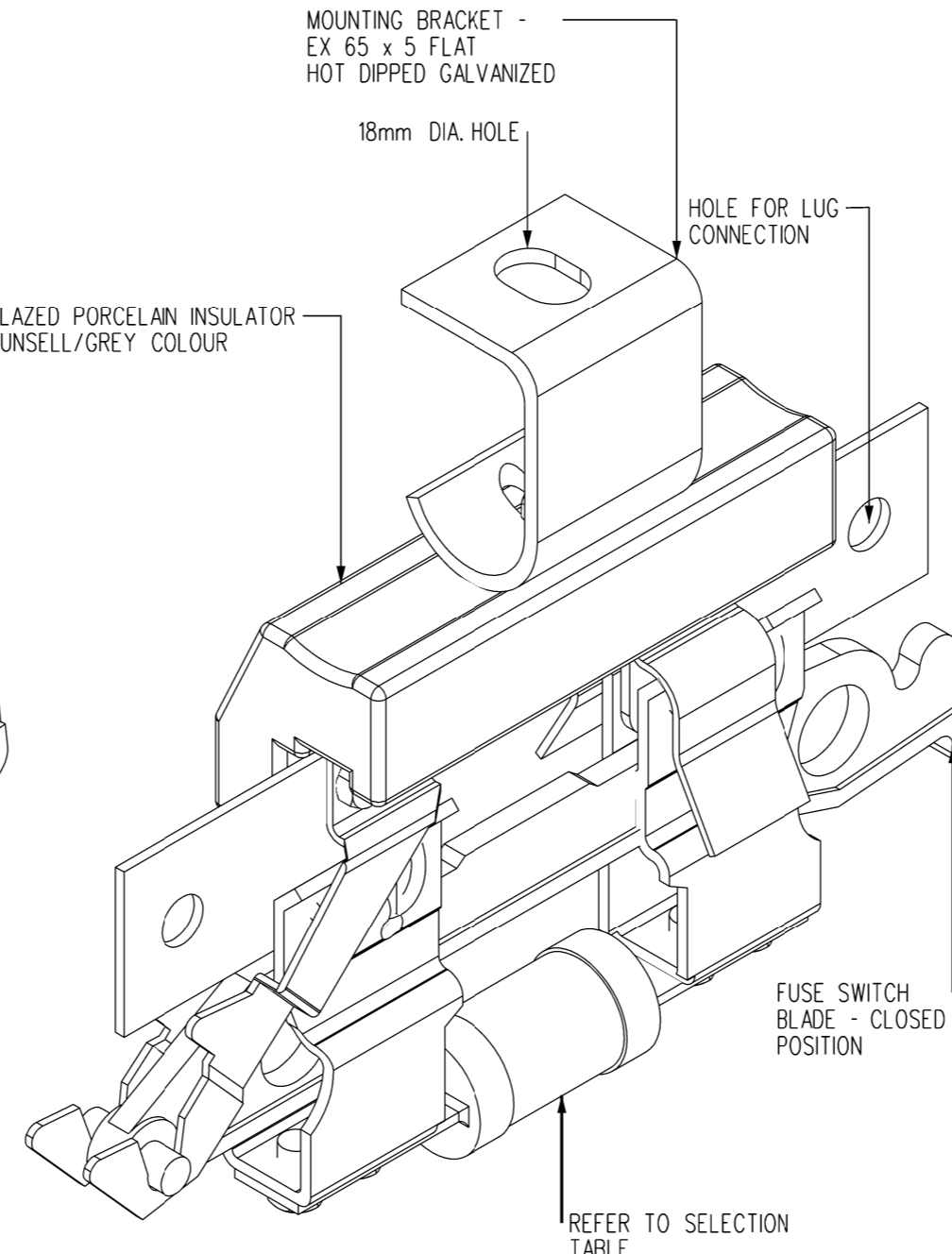

ITEM 2 - LV ISOLATING FUSE SWITCH (800A)

(Stock Code - 2238)

NO	DESCRIPTION	DRN	DATE	CKD	APPD
3	REDRAWN IN 3D TO REPRESENT ACTUAL.	J.C.	APR'09	A.T.	S.C.
2	NOTES 1 & 2 AMENDED	J.A.L.	JAN'97	A.G.B	F.R.R
AMENDMENTS					



DES	-	POWER STANDARD DRAWING		
DRN	gmck	SWITCH GEAR ISOLATING FUSE SWITCHES LV		
CKD	N.STUBBS			
APPD	B.KENT			
SCALE	...			
ISSUED	DEC'90	A3	DRAWING NUMBER	S01-1-6-08
ALL DIM. IN	mm			
DRAFTING STANDARD TO A.S.1100		CAD PRODUCT - DO NOT AMEND MANUALLY		

